



February 1, 2024

**SUBJECT: HACM-2023-RFP-03 General Contractor Services for
Pueblo Del Mar Apartments**

ADDENDA #01

Extended Close Date: 02/19/2024

- 1. Pueblo Del Mar site plans**
- 2. Priority list**
- 3. Updated Scope of Work (additional at the bottom)**
- 4. Home Depot Specs**
- 5. Questions**

Questions of a procedural nature may be directed
to Delayna Cambunga at (831)775-5064.
or dcambunga@hamonterey.org

MCS inc. MONTEREY COUNTY SURVEYORS, INC.
 235 Salinas Street, Salinas, California 93901
 424-1984x, 424-4099f, email: MCSINC@7@aol.com

Topographic Survey

Of a portion of the lands shown on map recorded in Volume 19 of Surveys at page 131 in the City of Marina, Monterey County, CA

MADE FOR: Housing Authority of the County of Monterey

SCALE: 1"=20' JOB NO. 18976 DATE: MAY 1999

SHEET 1 OF 1

- Notes**
1. Datum is approximate USGS (National Geodetic Vertical Datum of 1929).
 2. Contour interval is one (1) foot.
 3. Basis of Bearings: The bearing of N 28°16'42" W shown on the map recorded in Volume 19 of Surveys at page 131, as found monumented, was taken as basis of bearings shown upon this map.
 4. Location of subsurface utility lines taken from visual inspection only. No utility diagrams or other sources were used. Verify locations in the field by contacting U.S.A. prior to any excavation work.

- KEYED NOTES**
- ① (N) ACCESSIBLE PARKING, SEE SHT. A1.2.
 - ② (N) TOWAWAY SIGN, SEE DTL. 1.3/A1.2

- LEGEND**
-  (E) GROUND FLOOR UNITS ALTERED TO SUIT ACCESS COMPLIANCE REQUIREMENTS

- UNIT TABULATION**
- 53 (E) UNITS, NO CHANGE
 - 3 (E) UNITS W/ (N) ACCESS COMPLIANCE ALTERATIONS
 - 56 UNITS TOTAL

KASAVAN ARCHITECTS
 60 W. Market St., Suite 300
 Salinas, California 93901
 Voice 831.424.2232 Fax 831.424.2501

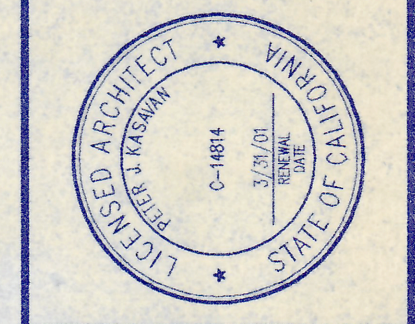

CONSULTANTS

The use of these plans and specifications shall be restricted to the original site for which they were prepared and publication thereof is expressly limited to such use. Re-use, reproduction, or publication by any method, in whole or in part, is prohibited. Title to the plans and specifications remains in the architect without prejudice. Visual contact with these plans and specifications shall constitute prima facie evidence of the acceptance of these restrictions.

ACCESS COMPLIANCE RENOVATION FOR THE HOUSING AUTHORITY OF THE COUNTY OF MONTEREY
 FIEBLO DEL MAR
 3069, 3071, 3091 11TH REGIMENT CT., MARINA, CALIF.
OVERALL SITE PLAN

SHEET NUMBER
A1.1
 DATE: 6/9/99
 JOB: 9740-3 DRAW: BLC



OVERALL SITE PLAN
 SCALE: 1"=40'-0"

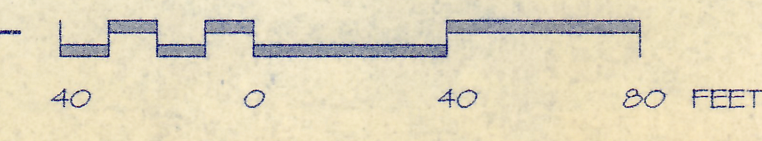

Pueblo Del Mar

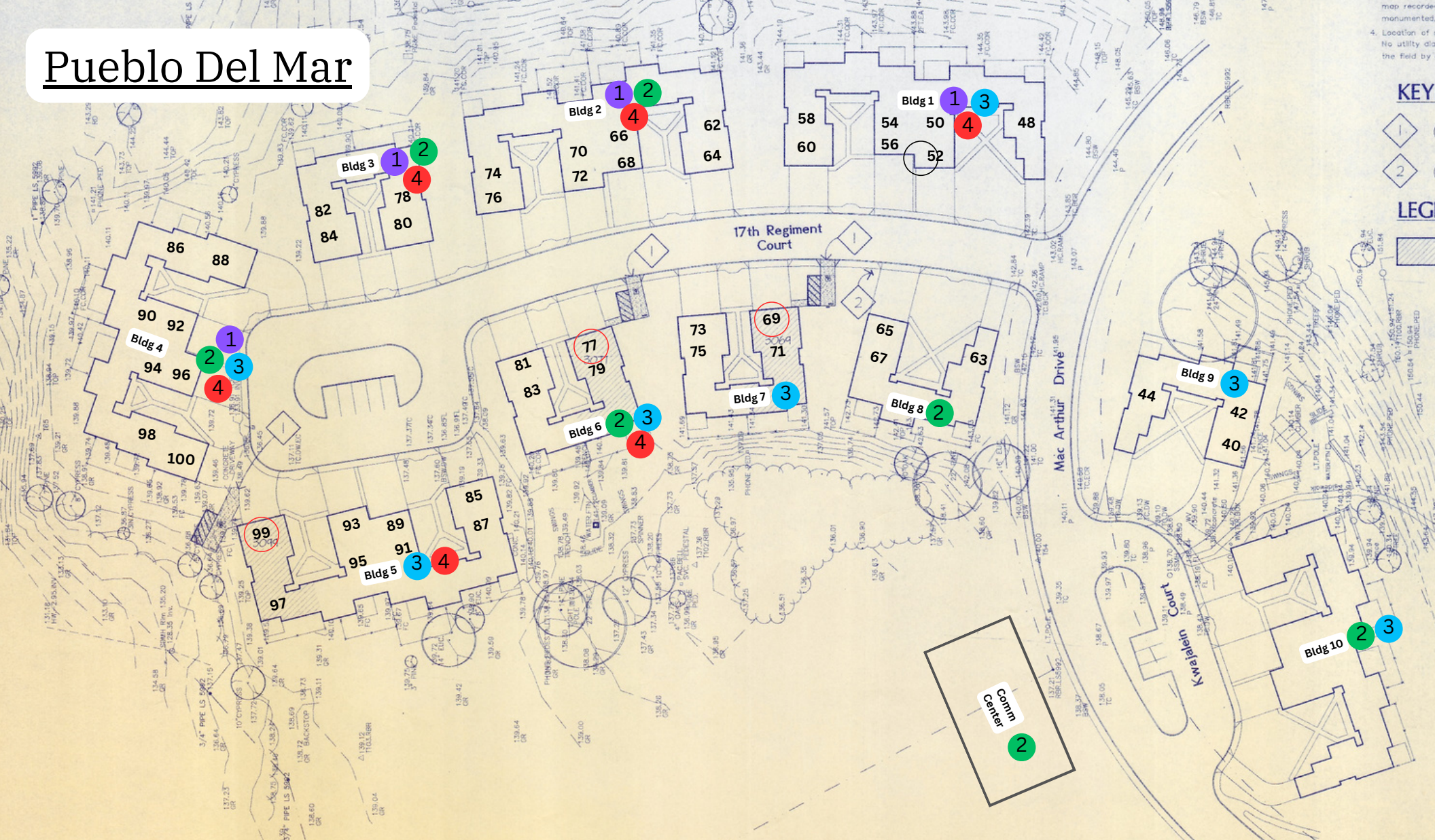

- 1. Building 1, 2, 3, 4 - Water Lines
- 2. Roofs & Gutters Buildings 2, 3, 4, 6, 8, 10, Comm Center
- 3. Stairwells Bldg 5 (Units 3085 & 3099) Bldg 4 (3098) Bldg 1 (3060 & 3052) Bldg 7 Bldg 6 Bldg 9 Bldg 10
- 4. Bldg 1 (3058), Bldg 2 (3066, 3072, 3074) Bldg 3 (3082) Bldg 4 (3096) Bldg 5 (3097) Bldg 6 (3083) Tubs need replacement
- 5. ADA Units (3069, 3077, 3099)

Attachment A

Scope of Work- By Project Manager Ricardo Calderon

ROOFING/GUTTERS:

1. Replace roofing asphalt tiles w/ a 30yr warranty installation to meet all trade standards. ASTM
2. Replace felt. 30 mil.
3. Relace any dry rot /termite damage roof decking.
4. Replace any dry rot/termite damaged fascia/trim. All fascia/trim to be premiered on all sides.
5. Replace all sheet metal. Vents /drip edge /Gutters and spouts/flashing.
6. Roof asphalt tiles COLOR TO BE DETERMINED BY OWNER.
7. All nailing and fasteners meet ASTM and building standards.
8. All debris to be disposed of by General Contract in a Lawful Manner.

TUB ENCLOSURE/TOILETS:

1. Install fiberglass Tub enclosure/Shower rod Chrome finish /In white
2. Replace tub valve with a single handle Delta Brand/showerhead/In chrome fixtures
3. Replace Toilets /to meet California code water conservation mandates, in white.
4. Paint and texture (knock down) all restroom walls /Paint in a Navajo White/ Semi Gloss finish
5. Replace light fixtures (LED)/ceiling fans
6. Replace flooring with linoleum /Color and texture to be determined by Owner.
7. All Restrooms to be move in ready /debris to be disposed of in a lawful manner by GC

GAS FURNACE:

1. All furnaces to be installed shall be energy efficient.
2. All furnaces to be installed by licensed Contractor in HVAC (Heating, Ventilation, Air Conditioning).
3. All piping to meet code standards that apply.
4. All vents' pipes must be properly secured and sealed.
5. All wiring to the thermostats properly connected /thermostats to be replaced.
6. All debris and metals to be disposed of in accordance with local/state/federal codes.

STAIRWELLS/RAILING/BALASTERS:

1. Replace fascia/Trim/ railing/baluster.
2. Primer all sides of lumber, and Paint to match finish.
3. Reseal deck/ Color to match.
4. Replace any dry rotted/termite damaged post/beams/header.
5. Install vapor barrier where required.
6. Replace damaged stringers, stubby post, wall rails. treads, riser.
7. Replace all and any mechanical fasteners.
8. All debris to remove in a lawful manner by Contractor.

BALCONIES/DECKS:

1. Replace baluster as needed and top cap /primer all sides and paint to match
2. Pressure wash decks and reseal/recoat matching color per manufacturer's instructions.
3. Replace brackets and replace dry rotted/termite damaged post / primer sealer all sides and paint to match.
4. All stucco related to balcony repair to be primed and paint and texture to match existing walls

5. All debris to be removed by Contactor in a lawful manner.

WINDOW REPLACEMENT:

1. All windows shall be energy efficient (with screens).
2. All windows will be of the same type/model throughout.
3. All windows will be retrofitted with stucco trim. (WATER PROOFING A MUST)
4. All windows will be sealed with a caulking that will be extreme expansion and long life. (years)
5. All windows will be of white color finish/paint and texture the inside walls/sills.
6. All debris to be removed in a lawful manner.

FOUNDATION >WATER LINE REROUTING:

1. Reroute the water line from the foundation through the cavity of the walls and ceiling as needed. All to be completed, to meet codes that govern the installation of plumbing.
2. The contractor will also complete all sheetrock repair, texture, and finish paint. Paint to match existing color and finish. Texture to be of same style finish. knock down, orange peel etc.
3. Copper or apex new generation can be installed- must meet plumbing codes.
4. Replace all or any ball valve.
5. All debris will be removed and disposed of in a lawful manner.

PRESUREWASH /PAINT EXTERIOR

1. Prep walls fill in any cracks /Pressure wash walls. (exterior)
2. Protect all properties that should not be painted; including personal property, cars, bikes, outside furniture etc.
3. Seal any exposed walls. Caulk shall be an extreme expansion type.
4. Color scheme to be chosen by owner. The paint will be an Elastomeric Exterior paint for stucco in the flat finish. The trim will be a semi-gloss finish.
5. All areas shall be clean of paints, cleaners, solvents, and debris disposed of in a lawful manner.

APPLIANCES:

1. All appliances will meet Housing Authority's standards, type/model/brand/Color/Manufacture.
2. All old existing appliances will be cataloged out of the system by HACM procurement, and all new appliances will be cataloged into the HACM system, before disposing/Installing of said appliance. Appliance deemed by HACM to retain will be by the sole discretion of HACM.
3. Appliances will be equipped with all and any necessary connections electrical cords /flex gas lines. All in safe length to allow tenants to clean behind appliance.

ADA COMPLIANCE UNITS: 3

1. Retrofit units to meet ADA requirements.
2. ADA Toilets, bathroom sink and tub faucet handles (Delta brand)
3. ADA mirror/ positioning of paper towel holder.
4. Properly positioned grab bars inside Bathroom.
5. Kitchen cabinets wheelchair access to kitchen sink /Faucet handles (ADA /Delta)
6. Low profile ADA tub enclosure w/ tub faucets w/ADA handle (Delta).
7. Front/rear door to meet ADA requirements.
8. Front/ rear threshold to be leveled or low-profile concrete ramp, to allow a wheelchair /scooter to enter the home.
9. ADA PART 2 (9) All modifications required to disturb walls and finishes. The contract shall prep walls, make any necessary repairs to walls and texture/ paint to match existing finishes and color.
10. Contractor to meet all requirements/ codes/ permit and inspections, where required.
11. All debris will be removed in a lawful manner.

COMMUNITY KITCHEN at Nancy Dodd Community Center:

1. Shall be fitted with a commercial stove- Rangehood w/fire suppressant system
2. Fit with stainless steel prep top and sink, because of the new commercial stove it will need to be fit with the proper pipe size to deliver the proper amount gas to the stove
3. The rangehood to be working with proper size wiring and breakers if needed .
4. The kitchen sink to be fitted with the proper size drain system required by governing code.
5. Contractor to follow through with any permits and schedule inspections
6. All existing appliances will need to be removed out of the HACM inventory before being removed out of the building or disposed of.
7. Also a small commercial refrigerator to be installed- stainless steel.
8. All appliances to be provided by the contractor with in the scope of work .

NANCY DODD COMMUNITY CENTER- additional Manager office remodel-

- 1. Remove wall that divides the office and storage room**
- 2. Patch area from existing wall**
- 3. All walls to match in paint and texture**
 - **Paint color chosen by HACM**
- 4. Storage room door to be removed and replaced with a window/ blinds**
 - **Exterior of window to match hallway in paint and texture**
- 5. Replace all flooring with LVP flooring**
 - **Base boards to be wood colonial style**
- 6. Install surface mounted LED light fixtures**

PDM Rehab Priority Schedule

High Priority	Rehab	Recontruction	Replacement
Roof /Gutters/Roof decking/Vents		Mid-Range	7 buildings
Deck reconstrution/front and rear decking/balconies		Mid-Range	28 decks
Stairwells /Railing/Balusters			9 units
Gas Furnaces /replace		Mid-Range	56 units
Tub replacement/old tile enclosure type			8 units
Foundation water line reouting			4 buildings
Window replacements /Low e rated			56 units
Nancy Dodd Community Center- Commercial			Kitchen area
Pressure Wash and Paint exterior			11 buildings
Appliances			
ADA requirement			Rehab 3 existing units
SECOND PRIORITY			
Concrete repair/Driveways/walkways	Walkways		
Asphalts repair /17th regiment entrance			
Flooring Community center			as needed
Kitchen Cabinets /Sinks/Faucets/Basin faucets			
THIRD PRIORITY			
Interior Painting	as needed		
Garage doors	as needed		
Playground			
Security Camaras			
Interior flooring /Carpet/ Linolium		as needed	

Questions

1. Q. Should permit fee be included in proposal?

A. Yes, please include estimated costs for permits

2. Q. Will the additional scope of work be included in the budget?

A. Yes, please account for any costs connected to the additional work

3. Q. Can materials be stored on site?

A. Yes, with no accountability to HACM

4. Q. Will there be an Architect?

A. No, all work is replacing and repairing what is currently there. There will be no modifying to the foot print.

5. Q. How can we get exact measurements?

A. You can call Ricardo, Delayna or Pablo to schedule a time to gain access to the property.

2603TRIO 60 x 30 AcrylX Alcove Three-Piece Tub Shower

Model number:

2603TRIOL-WH

Dimensions: 60" x 30" x 72"

Installation: Alcove

Material: AcrylX™



Standard Features:

- 3-Piece tub shower ideal for remodeling projects
- Classic smooth wall finish is easy to maintain
- Molded toiletry shelves (on right side of unit, regardless of drain option)
- Ergonomic backrest for bathing comfort
- Left or right hand drain

Product characteristics:

- Multi-Piece Unit
- Integrated Shelving
- Smooth Walls

Standard Colors:



White



Bone

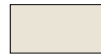

Biscuit

Certifications

AQUATIC products adhere to one or more of the following certifications:



2603TRIO 60 x 30 AcryIX Alcove Three-Piece Tub Shower

Model number:

2603TRIOL-WH

Dimensions: 60" x 30" x 72"

Installation: Alcove

Material: AcryIX™

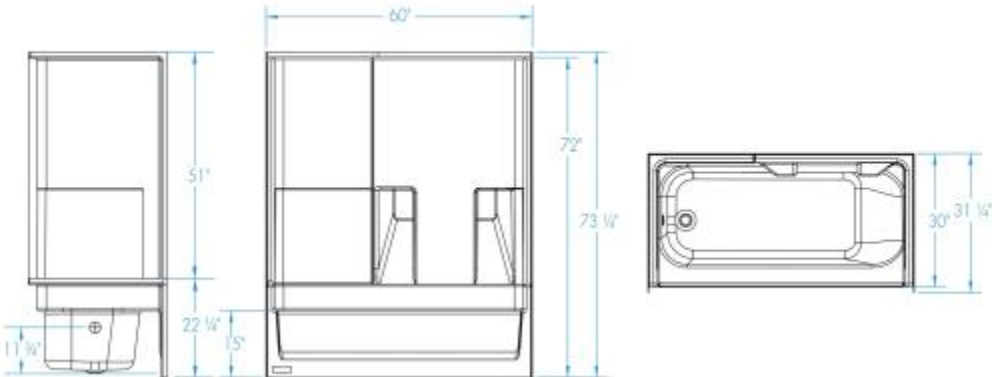

Dimensions

60 x 30 x 72 In.
(1524 x 762 x 1829 mm)

Water Capacity

42 gallons

Weight

138 lbs - 62 1/2 kg

Deep Sump Height

9.875 In. - 251 mm

Drain location:

Left

Right

Project: _____

Contractor: _____

Representative: _____

Date: _____

Tel: _____

Notes: _____





see what Delta can do™

MULTICHOICE® UNIVERSAL ROUGH VALVE BODY

- R10000-UN (Universal Inlets/Outlets)
- R10000-UNBX (Universal Single Box Model)
- R10000-UNBXHF (High Flow Shower Only)
- R10000-UNBXT (Thin Wall)
- R10000-UNWS (Universal with Stops)
- R10000-UNWSHF (High Flow with Stops)
- R10000-UNWSBXT (Thin Wall with Stops)
- R10000-PX (Pex Crimp Connections with UN Outlets)
- R10000-PXWS (Pex Crimp Connections with Stop with UN Outlets)
- R10000-IP (IPS Inlets/Outlets)
- R10000-IPWS (IPS with Stops)
- R10000-MF (Pex Cold Expansion Connections with UN Outlets)
- R10000-MFWS (Pex Cold Expansion with Stops with UN Outlets)

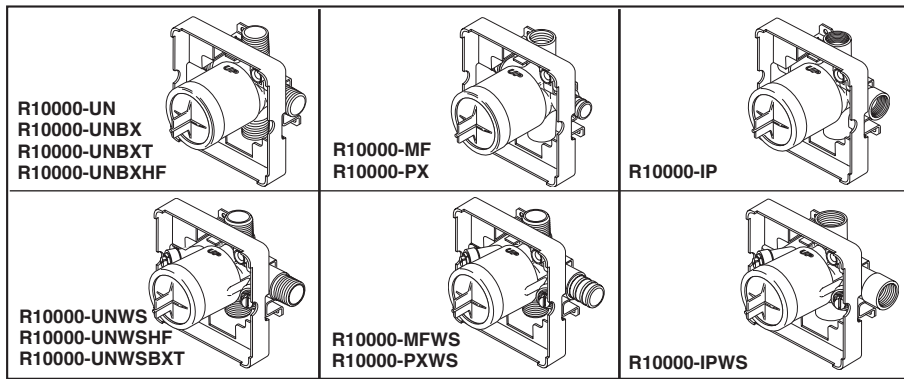

Submitted Model No.: _____

Specific Features: _____

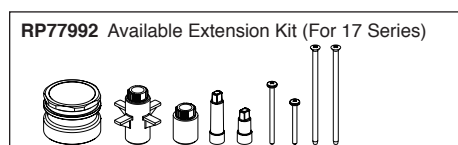
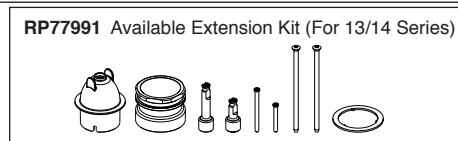
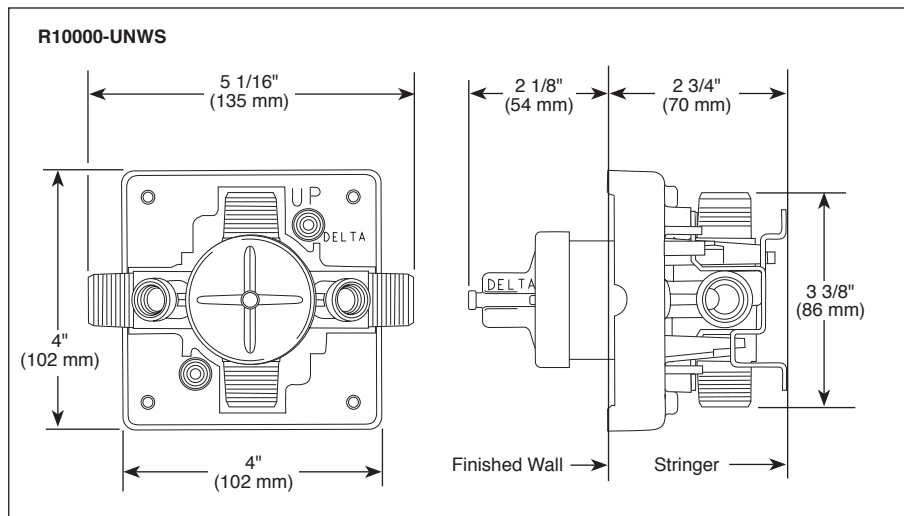
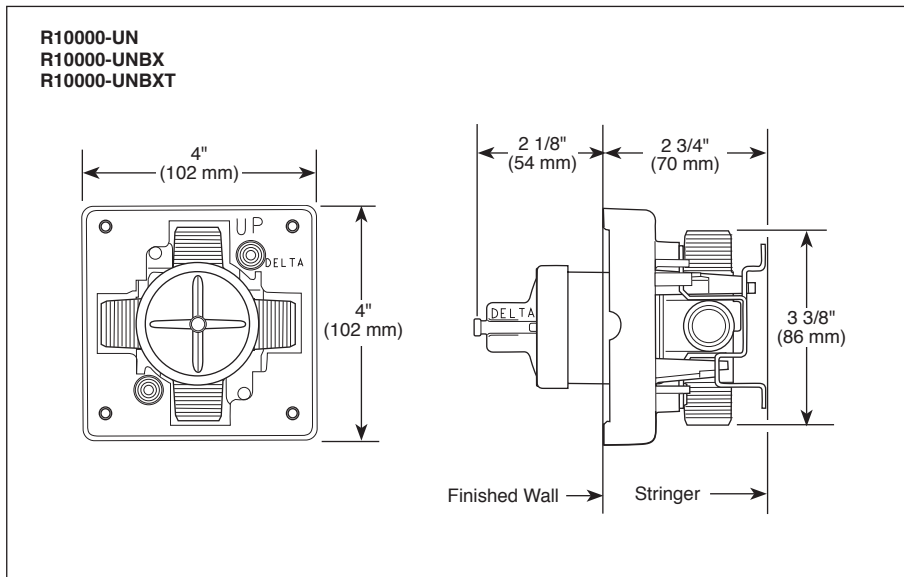

STANDARD SPECIFICATIONS:

- Forged brass body.
 - Back-to-Back installation capabilities.
 - Can be tested with air (200 PSI) or water (300 PSI) without valve using supplied test cap.
 - Square plasterguard allows for right angle cuts.
 - Thin wall mounting.
 - For use with MultiChoice® Universal single or dual function trim. Cartridge ships with trim.
 - 1/2" outlets and connections.
- Note: No tub outlet in HF model.
 Note: Should use proper fitting with each type (copper tubing, iron pipe, and pex fitting).
 Note: Should use proper tooling with crimping pex fitting and cold expansion pex models.
 Note: IP indicates female 1/2" threaded connections.
 Note: UN indicates Universal type fitting and is 1/2" NPT male thread with 1/2" C.W.T. female sweat.

WARRANTY

- Lifetime limited warranty on parts (other than electronic parts and batteries) and finishes: or, for commercial users, for 5 years from date of purchase.
- 5 year limited warranty on electronic parts (other than batteries); or, for commercial users, for 1 year from the date of purchase. No warranty is provided on batteries.

COMPLIES WITH:

- ASME A112.18.1 / CSA B125.1

Delta Faucet Company
 55 E. 111th Street, Indianapolis, IN 46280
 350 South Edgeware Road, St. Thomas, ON N5P 4L1
 © 2017 Delta Faucet Company

Delta reserves the right (1) to make changes in specifications and materials, and (2) to change or discontinue models, both without notice or obligation. Dimensions are for reference only. See current full-line price book or www.deltafaucet.com for finish options and product availability.

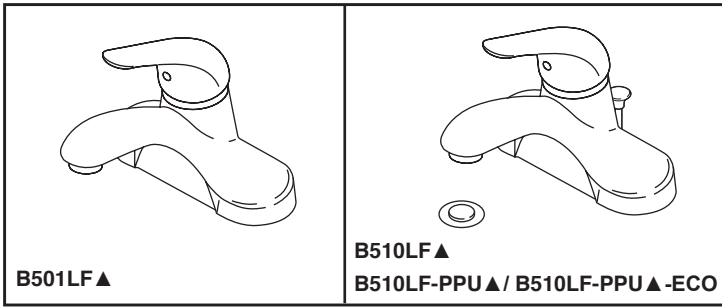

see what Delta can do™

BATHROOM FAUCETS

■ Single Handle Deck Mount

Submitted Model No.: _____

Specific Features: _____

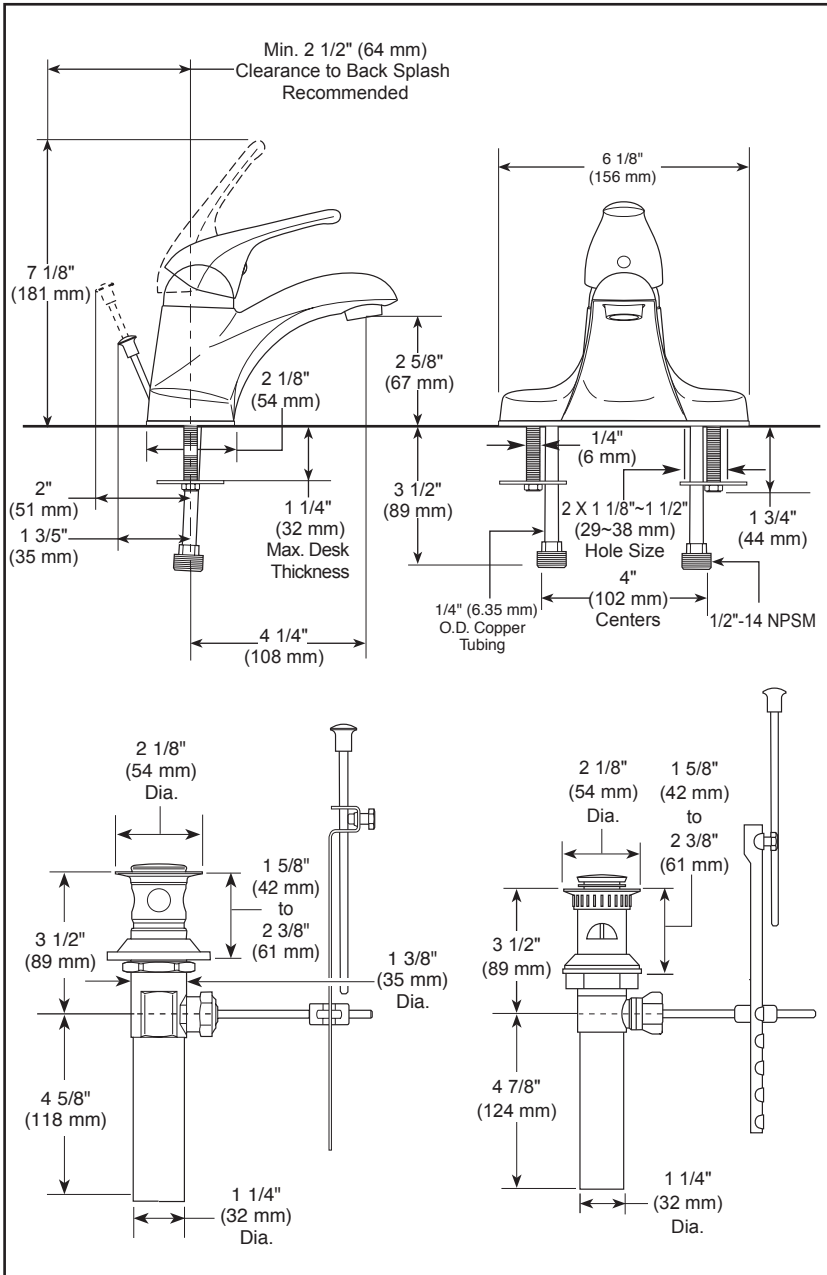

▲ Designate proper finish suffix

STANDARD SPECIFICATIONS:

- Max. flow rate: 1.2 gpm @ 60 psi, 4.54 L/min @ 414 kPa
- Solid brass fabricated body
- Single handle lavatory faucets for exposed mounting on 3 hole sinks with 4" centers
- All operating parts shall be replaceable from the top
- Control mechanism is the rotating stainless steel ball type with replaceable non-metallic seats
- Control handle shall return to neutral position when valve is turned off
- Metal drain with pop-up type fitting with plated flange and stopper
- Models with "PPU" have plastic pop-up type fitting with plated flange and stopper
- Models with "LH" no drain and no lift rod hole

WARRANTY

- Parts and Finish - Lifetime limited warranty; or for commercial purchasers, 10 years for multi-family residential (apartments and condominiums) and 5 years for all other commercial uses, in each case from the date of purchase.
- Electronic Parts and Batteries (if applicable) - 5 years from the date of purchase; or for commercial purchasers, 1 year from the date of purchase. No warranty is provided on batteries.



COMPLIES WITH

- ASME A112.18.1 / CSA B125.1
- ASME A112.18.2 / CSA B125.2
- ♿ Indicates compliance to ICC / ANSI A117.1 - Valve control only
- EPA WaterSense®

Delta reserves the right (1) to make changes in specifications and materials, and (2) to change or discontinue models, both without notice or obligation. Dimensions are for reference only. See current full-line price book or www.deltafaucet.com for finish options and product availability.



see what Delta can do™

TUB AND SHOWER FAUCET TRIM

- Classic Bath Collection
- Valve Only (T13022 Series)
- Shower Only (T13222 Series)
- Tub/Shower (T13422 Series)

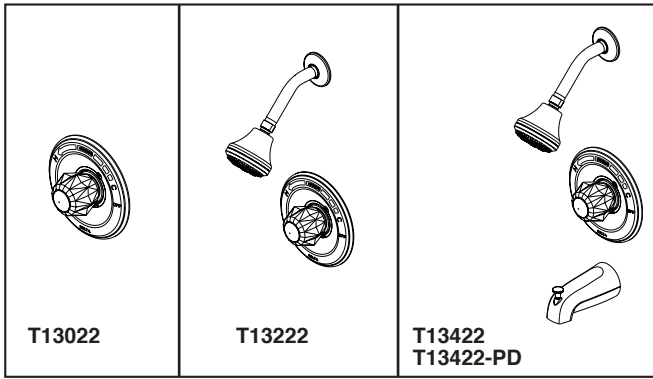

Submitted Model No.: _____

Specific Features: _____

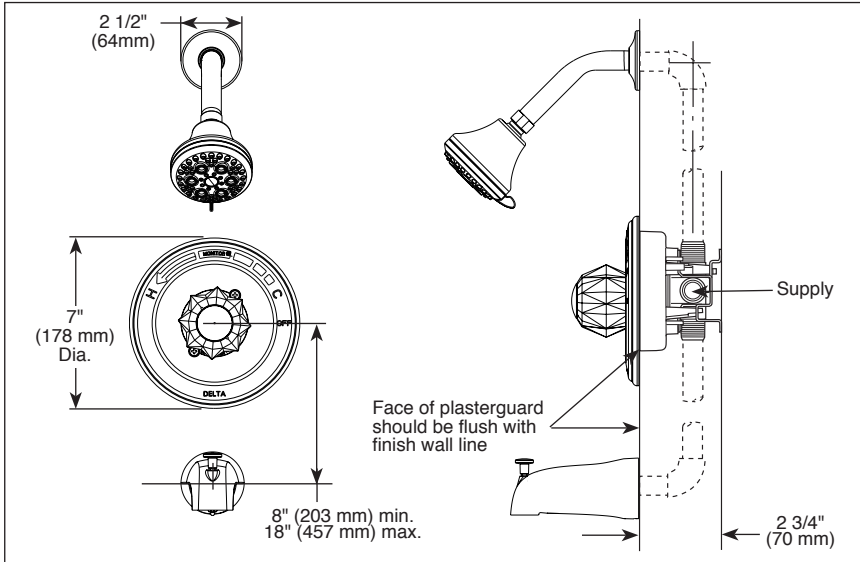

FEATURES:

- Monitor® 13 Series pressure balanced bath mixing valve

STANDARD SPECIFICATIONS:

- Shower head max flow rate 1.75 gpm @ 80 psi, 6.6 L/min @ 550 kPa
- Maintains a balanced pressure of hot and cold water even when a valve is turned on or off elsewhere in the system
- For use with MultiChoice® Universal rough valve body. (R10000 Series)
- Back-to-back installation capability
- Solid brass fabricated body
- Temperature only controlled with handle. Clear knob handle with red/blue indicators
- Field adjustable to limit handle rotation into hot water zone
- 120° maximum handle rotation
- All parts replaceable from the front of the valve
- Models with "PD" suffix supplied with 6" long pull-down diverter spout (RP101818)
- Tub port max flow rate 8.6 gpm @ 60 psi with R10000-UNBX
- Universal tub spout adapter included allows for thread, sweat or slip-on installation
- **Note:** Product will be marked with flow rate of specific shower head

WARRANTY

- Parts and Finish - Lifetime limited warranty; or for commercial purchasers, 10 years for multi-family residential (apartments and condominiums) and 5 years for all other commercial uses, in each case from the date of purchase.
- Electronic Parts and Batteries (if applicable) - 5 years from the date of purchase; or for commercial purchasers, 1 year from the date of purchase. No warranty is provided on batteries.



COMPLIES WITH:

- ASME A112.18.1 / CSA B125.1
- ASSE 1016
- EPA WaterSense® - Applies to T13222, T13422, T13422-PD & 52634-18-PK

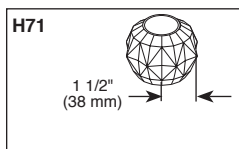
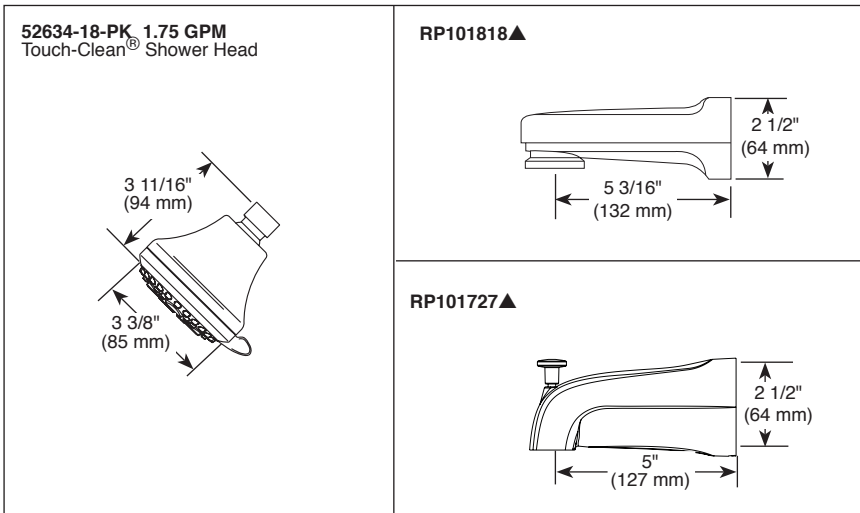

▲ Designate Proper Finish Suffix

Delta reserves the right (1) to make changes in specifications and materials, and (2) to change or discontinue models, both without notice or obligation. Dimensions are for reference only. See current full-line price book or www.deltafaucet.com for finish options and product availability.

Delta Faucet Company

55 E. 111th Street, Indianapolis, IN 46280
 350 South Edgeware Road, St. Thomas, ON N5P 4L1
 © 2021 Delta Faucet Company

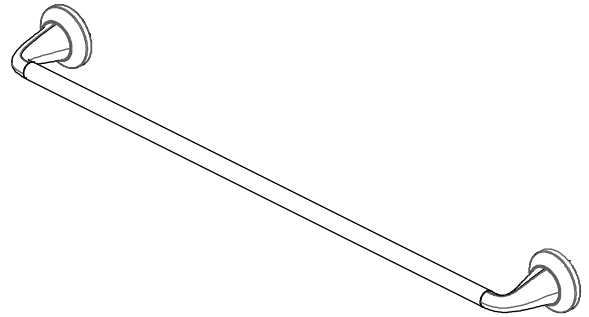

FEATURES

- 26.28" L x 2.28"W x 3"H
- Coordinates with Constructor Series Bath Products
- Easy Installation
- Includes Mounting Hardware and Plastic Anchors
- Tools Required for Installation:
 - Drill with 1/4" Drill Bit
 - Philips Screwdriver
 - Small Flat Head Screwdriver

**Constructor Series
Classic Collection**

24" Towel Bar

MODEL	FINISH
20118-0201	Chrome Polished

Available for purchase or special order at Home Depot stores.

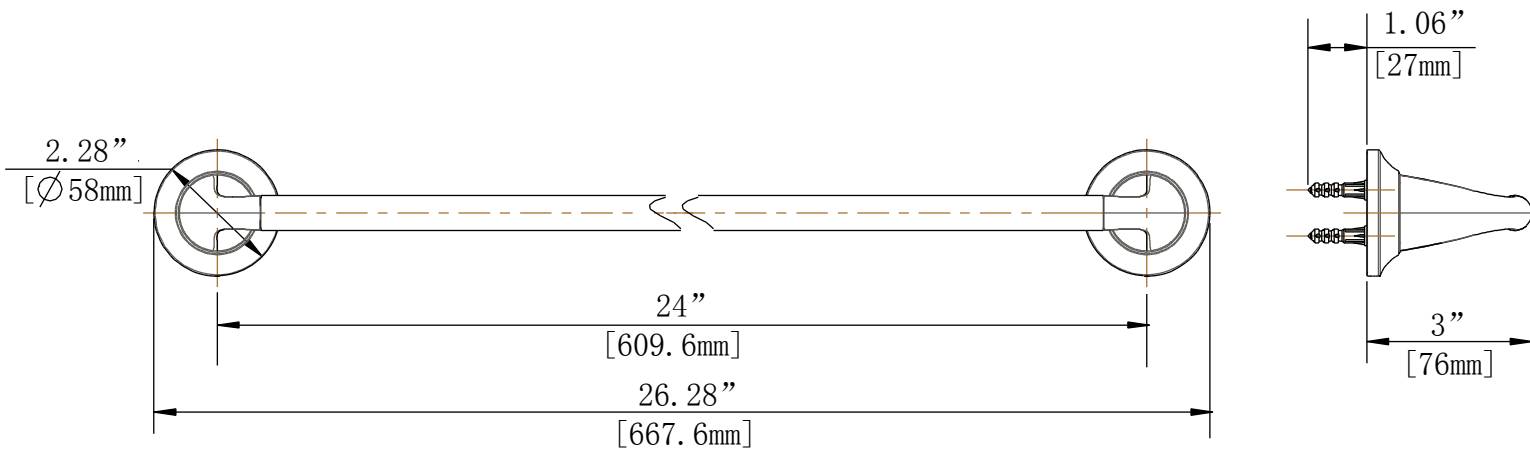

INSTALLATION DIMENSIONS

Glacier Bay reserves the right to make changes in specifications and materials and to change and discontinue models, both without notice or obligation. Dimensions are for reference only.

1.28 GPF POWER FLUSH ELONGATED All-In-One Toilet

SKU: 1004-159-514

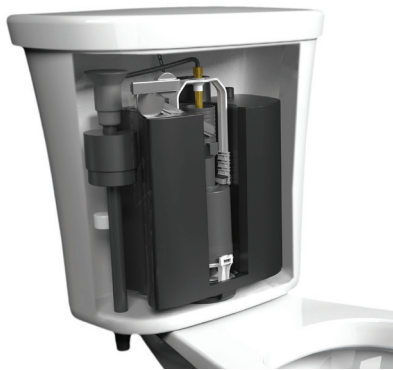

**Stealth®
Vacuum-
Assist Power
Chamber
Inside**



FEATURES

- Patented Niagara Stealth® flush technology for the ultimate flush performance
- Saves money and uses 20% less water than a 1.6 GPF toilet and 60% less water than a 3.5 GPF toilet
- Meets HET rebate standards - high rebate dollars
- Slow close seat with easy clean hinge
- QuickConnect™ Installation System
- Large water spot for a clean bowl
- 12" rough-in
- 2 3/8" fully glazed trapway for clog free flush performance
- Extra large 10.25" x 23.5" footprint, excellent for retrofitting
- Limited Lifetime Warranty



FLUSH
POWER



CHAIR
HEIGHT



ELONGATED
BOWL

INCLUDES:

- | | |
|------------------------------------------|------------------------------------------------|
| <input checked="" type="checkbox"/> TANK | <input checked="" type="checkbox"/> BOLTS/CAPS |
| <input checked="" type="checkbox"/> BOWL | <input checked="" type="checkbox"/> WAX RING |
| <input checked="" type="checkbox"/> SEAT | <input type="checkbox"/> SUPPLY LINE |

Included Not Included

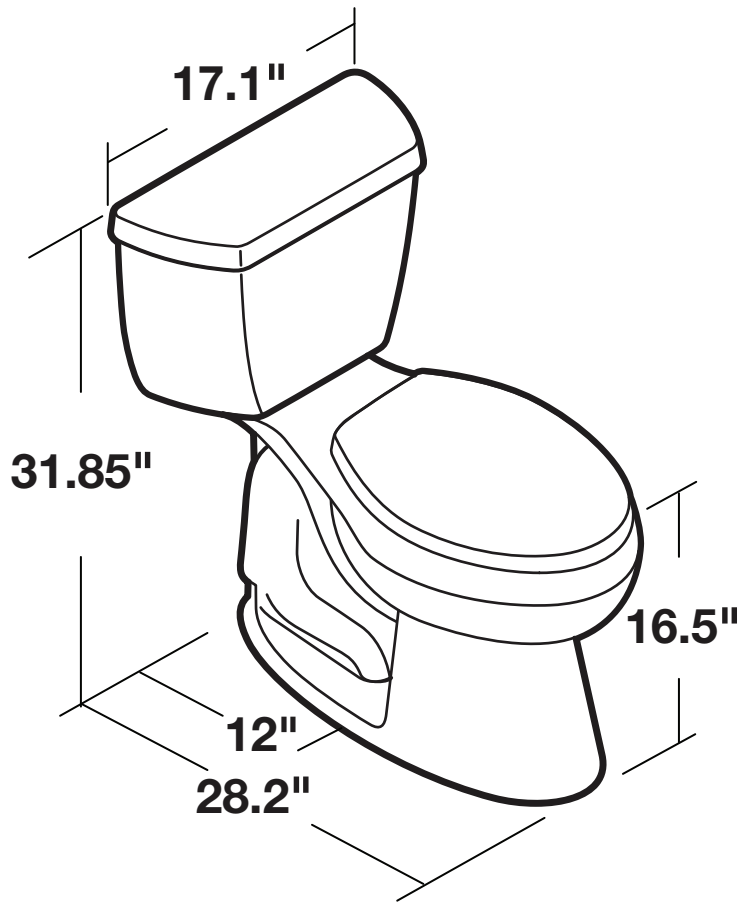

**ASSEMBLED SIZE:**

28.2" Length
17.1" Width
31.85" Height

WARRANTY INFO

Glacier Bay products are manufactured with superior quality standards and workmanship and are backed by our limited lifetime warranty. Glacier Bay products are warranted to the original consumer purchaser to be free of defects in materials or workmanship. We will replace FREE OF CHARGE any product or parts that proves defective. Simply, return the product / part to any of The Home Depot retail locations or call 1-855-HD Glacier (1-855-434-5224) to receive the replacement item. Proof of purchase (original sales receipt) from the original consumer purchaser must be made available for all Glacier Bay warranty claims.

This warranty excludes incidental/inconsequential damages and failures due to misuse, abuse or normal wear and tear. This warranty excludes all industrial, commercial and business usage, whose purchasers are hereby, extended a five year limited warranty from the date of purchase, with all other terms of this warranty applying except the duration of warranty.

Some states and provinces do not allow the exclusion or limitation of incidental or consequential damages, so the above limitations may not apply to you. This warranty gives you specific legal rights and you may also have other rights that vary from state to state and province to province. Please see a store or contact 1-855-HD Glacier for more details.

Contact the Customer Service Team at 1-855-434-5224 or visit www.HomeDepot.com

INSTALLATION NOTES

Install this product according to the installation guide. For back-to-back toilet installations: Use only a 45° double wye fitting. Will comply with the Americans with Disabilities Act (ADA) when installed per the requirements of the 2010 ADA Standards of Accessible Design, Section 604 Water Closets, of the Act. The Model Plumbing Codes require the installation of elongated open-front toilet seats in public bathrooms. Will comply with CSA B651 when installed per Clause 4.3.6 of the standard. Will comply with OBC Barrier Free requirements when installed per Clause 3.8.3.8 and 3.8.3.9.

ID	Description	Technology	Status
N3122GB -W	Newport 31x22 White Vtop	AB Composite	Approved for production

Rev #	Approved by	Change
0	R. Rubio	Released

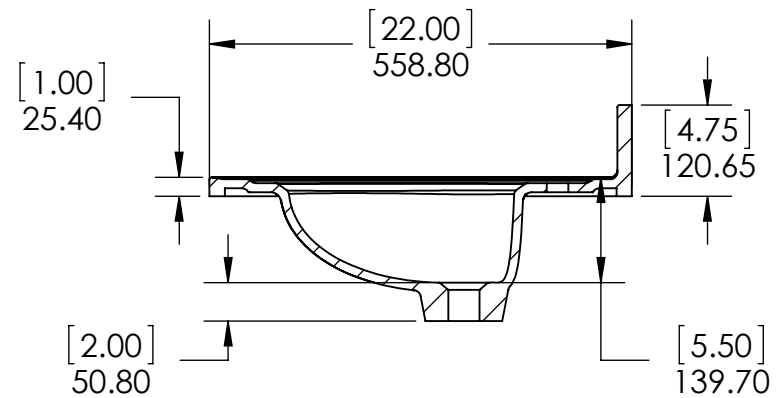
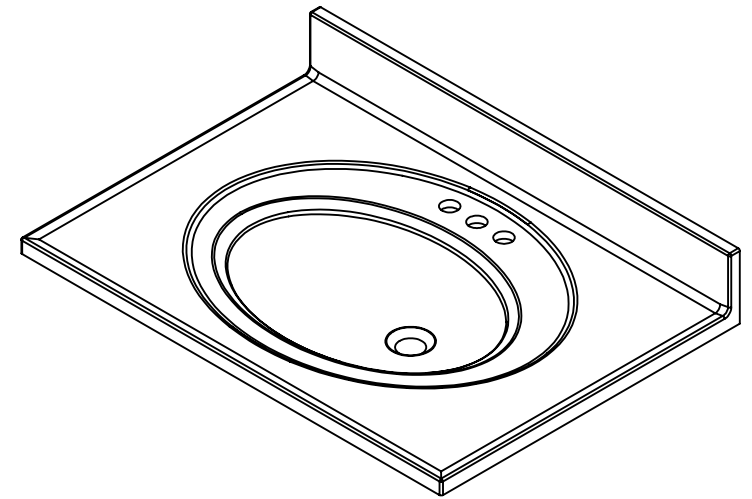
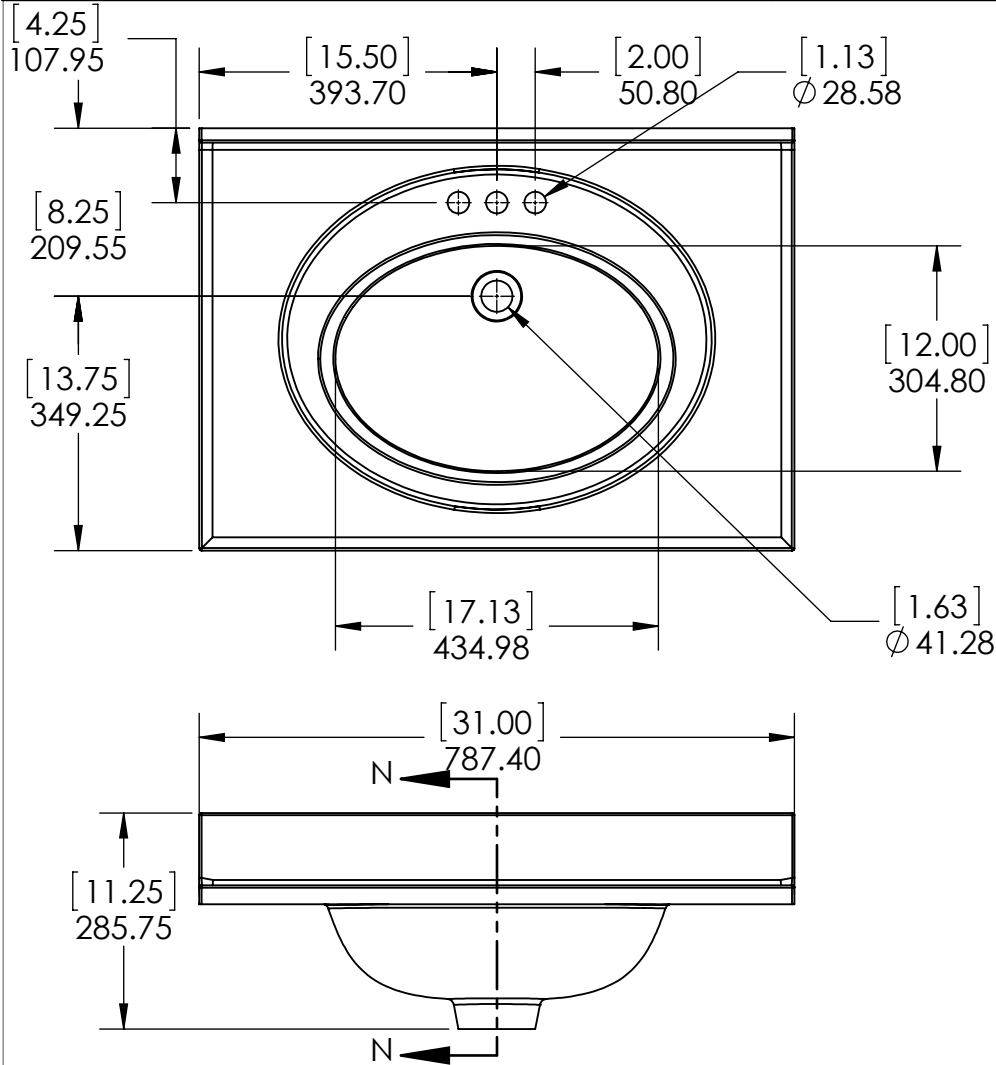

PROPRIETARY AND CONFIDENTIAL
 THE INFORMATION CONTAINED IN THIS DRAWING IS THE
 SOLE PROPERTY OF WOODCRAFTERS. ANY
 REPRODUCTION IN PART OR AS A WHOLE WITHOUT THE
 WRITTEN PERMISSION OF WOODCRAFTERS IS PROHIBITED.

UNLESS OTHERWISE SPECIFIED
 DIMENSIONS ARE IN MM.
 AND (INCHES)
 TOLERANCES ARE
 +0.125 [3.175] -0.125 [-3.175]
 SCALE:1:10

	NAME	DATE
DRAWN	R. Rubio	04/24/17
CHECKED	R. Rubio	04/24/17
ENG APPR.	R. Rubio	04/24/17
MFG APPR.	C. Leal	04/24/17



SIZE	DWG. NO.	SHEET 1 OF 1	REV: 0
A	Newport 31x22 White Vtop		



Item#1000046023,1000046025,
1000046026,1000046027
Model #GB11, GB12, GB21, GB22

USE AND CARE GUIDE

MEDICINE CABINET

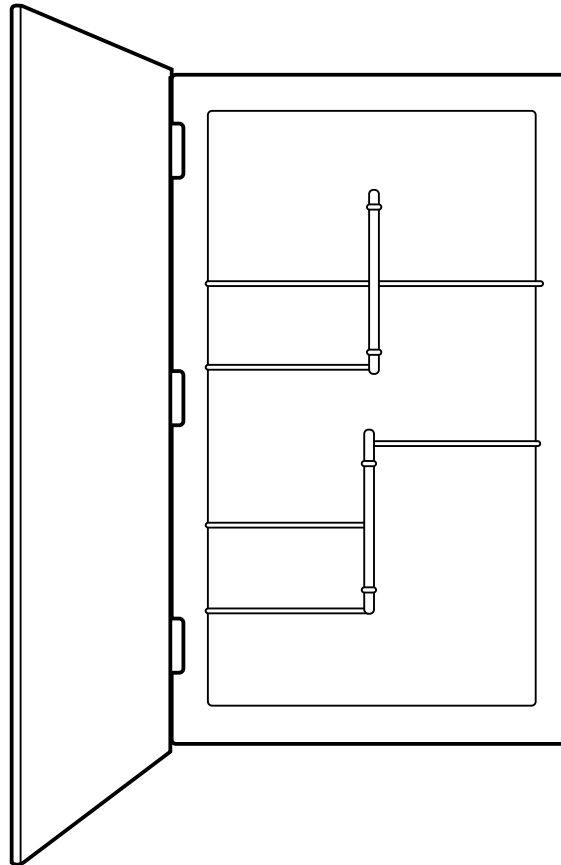

Questions, problems, missing parts? Before returning to the store,
call Glacier Bay Customer Service
8 a.m. - 6 p.m., EST, Monday-Friday

1-855-HDGLACIER

HOMEDEPOT.COM

THANK YOU

We appreciate the trust and confidence you have placed in Glacier Bay through the purchase of this medicine cabinet. We strive to continually create quality products designed to enhance your home. Visit us online to see our full line of products available for your home improvement needs. Thank you for choosing Glacier Bay!

Table of Contents

Table of Contents.....	2	Tools Required	3
Safety Information.....	2	Hardware Included.....	3
Warranty.....	2	Package Contents	4
Limited Lifetime Warranty.....	2	Installation	5
Pre-Installation	3	Care and Cleaning	6
Planning Installation	3		

Safety Information

Read and understand these instructions before you install this product.

- The maximum weight capacity for this medicine cabinet is 25 lbs.



CAUTION: Risk of electric shock. Electrical wiring may need to be relocated if installing in a new location. Please consult a qualified electrician.

NOTICE: Any electrical or plumbing obstructions should be removed or relocated by qualified trade personnel in strict compliance with all applicable building codes.

Warranty

LIMITED LIFETIME WARRANTY

Glacier Bay products are manufactures with superior quality standards and workmanship and are backed by our lifetime warranty. Glacier Bay Products are warranted to the original consumer purchaser to be free of defects in materials or workmanship. We will replace FREE OF CHARGE any product or parts that proves defective. Simply, return the product / part to any of The Home Depot retail locations or call 1-855-HDGLACIER (1-855-434-5224) to receive the replacement item. Proof of purchase(original sales receipt) from the original consumer purchaser must be made available for all Glacier Bay warranty claims.

This warranty excludes incidental/inconsequential damages and failures due to misuse, abuse or normal wear and tear. This warranty excludes all industrial, commercial & business usage, whose purchaser are hereby, extended a five year limited warranty from the date of purchase, with all other terms of this warranty applying except the duration of the warranty.

Some states and provinces do not allow the exclusion or limitation of incidental or consequential damages, so the above limitations may not apply to you. This warranty gives you specific legal rights and you may also have other rights that vary from state to state and province to province. Please see a store or contact 1-855-HDGLACIER for more details.

Pre-Installation

PLANNING INSTALLATION

This medicine cabinet is designed for recessed installation in a standard wall opening 14 in. wide, 24 in. or 34 in. high, and 3½ in. (or more) deep.



NOTE: A mounting kit is available for purchase from The Home Depot if you wish to install this medicine cabinet directly to a wall. Model number GBF26.

TOOLS REQUIRED



Pencil



Safety goggles

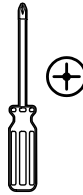

Phillips screwdriver



Level



Tape measure



Stud finder

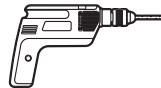

Drill



.078 Drillbit

HARDWARE INCLUDED



NOTE: Hardware not shown to actual size.

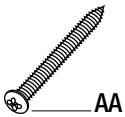

Part	Description	Quantity
AA	Mounting screw	4

Pre-Installation (continued)

PACKAGE CONTENTS

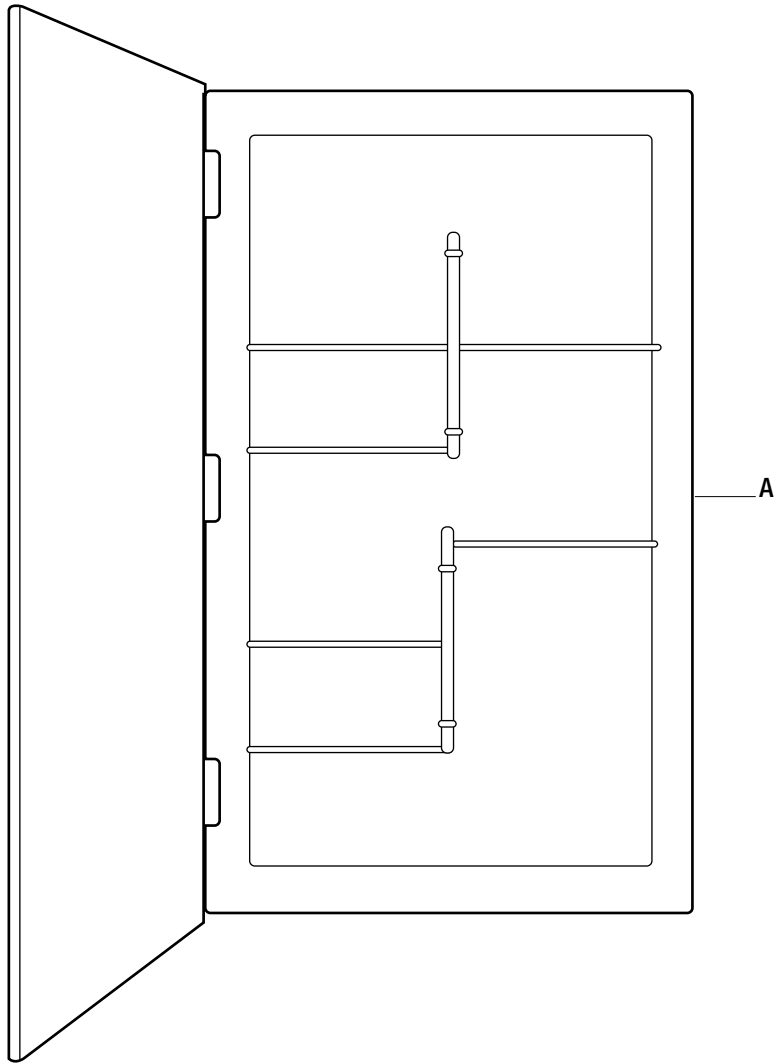

Part	Description	Quantity
A	Medicine cabinet	1

Installation

1 Preparing for installation

NOTICE: Any electrical or plumbing obstructions should be removed or relocated by qualified trade personnel in strict compliance with all applicable building codes.

- To replace an existing cabinet, remove the old cabinet and verify that the wall opening is 14 in. wide, 24 in. high, and 3½ in. (or more) deep. Proceed to step 2 if these dimensions are correct.
- For a new installation, select a wall opening site that is centered between wall studs that are positioned 16 in. on center. Use a stud finder to locate the studs.
- The center of the wall opening is commonly located 60 in. above the floor. Alter this dimension to suit individual needs or to facilitate clearance between the top or bottom of the hinged mirror and obstacles such as counter top, faucet, electrical outlet, light fixture, ceiling, etc.
- Mark and cut the 14 in. wide x 24 in. high wall opening. Use a level to ensure the cut lines are level before you begin cutting the wall.

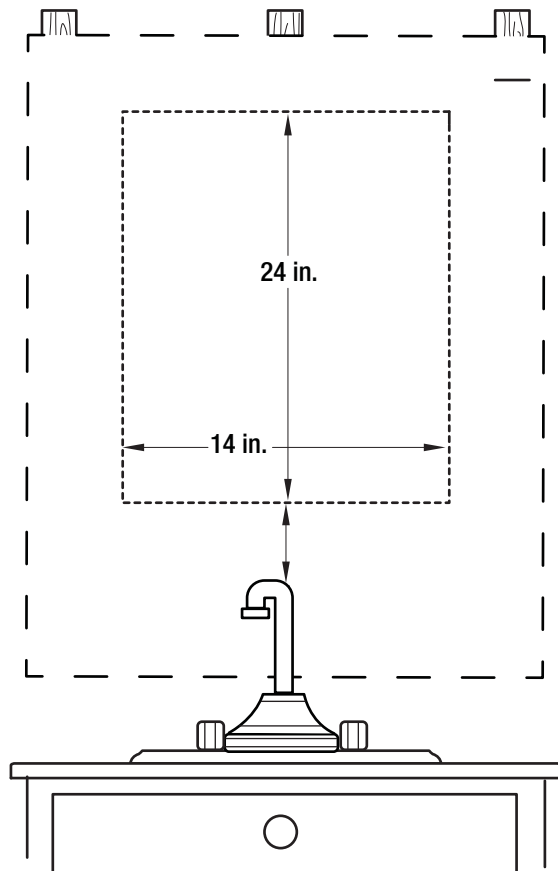

2 Mounting the cabinet

- Place the cabinet in the wall opening with the top of the cabinet body return flange held fully against the wall. Noting that the mounting system inside the cabinet positions the mounting screws (AA) at a 15° angle, install two screws (AA) in the upper mounting holes inside the cabinet. Use only the screws provided (do not use nails). Do not fully tighten the screw heads into the nests at this time; leave approximately ¼ in. of thread exposed. To assist with the installation, mark and drill .078 in. diameter pilot holes (at the 15° angle) into the studs and/or coat the screw threads with soap.
- Install two screws (AA) in the lower mounting holes. Leave ¼ in. of the thread exposed.
- Some walls are not flat and plumb. Using a carpenter's level, adjust as necessary to level the cabinet as viewed facing the cabinet and viewed from the side. Check the fit of the cabinet door to the cabinet body flange. Correct any gap between the door and body by shimming as necessary between the wall and the body flange at the corner diagonally opposite the gap. (Example: If the gap is top/right, shim bottom/left). Adjust the shim thickness for cross-axis alignment to achieve a satisfactory fit between the door and body.
- Tighten all four mounting screws (AA) until the screw heads are just seated in their nests. **DO NOT OVERTIGHTEN!**

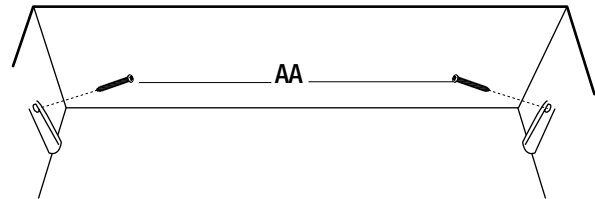

Care and Cleaning

- The best and safest cleaner for a mirror is clean water used with a soft cloth.
- Never spray anything directly onto a mirror. Instead, apply the cleaner to a soft cloth and then wipe the mirror.
- Never use any acid, alkali, abrasive or ammonia-based cleaners; they are likely to destroy the mirror and will void the warranty.
- Avoid drips and “puddling” at the mirror edge.
- Thoroughly dry all mirror edges.
- Medicine cabinets should be one of the last items installed in new construction to avoid contact with solvents, cleaners, etc.
- In humid climates, install mirrors after air conditioning is operational.
- Good ventilation will keep mirrors from “sweating” and creating harmful condensation.



Questions, problems, missing parts? Before returning to the store,
call Glacier Bay Customer Service
8 a.m. - 6 p.m., EST, Monday-Friday

1-855-HDHAMPTON

HOMEDEPOT.COM

Retain this manual for future use.

GUIDE D'UTILISATION ET D'ENTRETIEN

ARMOIRE À PHARMACIE

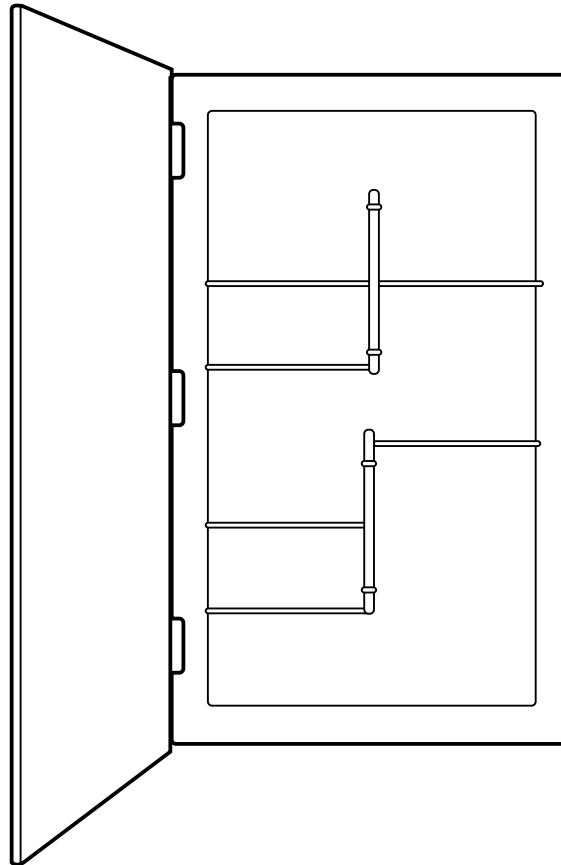

Questions, problèmes, pièces manquantes? Avant de retourner au magasin, appelez le service à la clientèle de Glacier Bay de 8h à 18h, heures normales de l'Est, du lundi au vendredi

1-855-HD-GLACIER

HOMEDEPOT.COM

MERCI

Nous apprécions la confiance que vous avez placée dans Glacier Bay par l'achat de cette armoire de pharmacie. Nous nous efforçons continuellement de créer des produits de qualité conçus pour améliorer votre maison. Visitez-nous en ligne pour voir notre gamme complète de produits disponibles pour vos besoins de rénovation. Merci d'avoir choisi Glacier Bay!

Table des matières

Table des matières.....	2	Matériel inclus	3
Garantie À Vie Limitée.....	2	Contenu.....	4
Préinstallation.....	3	Installation	5
Planification de l'installation.....	3		
Outils nécessaires.....	3		

Mesures de sécurité

Lire et comprendre ces instructions avant d'installer ce produit.

- La capacité de charge maximale pour cette armoire de pharmacie est de 25 lb.



MISE EN GARDE : Risque de décharges électriques. Le câblage électrique pourrait devoir être réinstallé si vous effectuez l'installation dans un nouvel emplacement. Veuillez consulter un électricien qualifié.

AVIS : Toute obstruction électrique ou de plomberie devrait être retirée par un professionnel qualifié avec une stricte conformité avec les codes du bâtiment en vigueur.

Garantie

GARANTIE À VIE LIMITÉE

Les produits Glacier Bay sont fabriqués avec des normes de qualité supérieure et sont soutenus par notre garantie à vie limitée. Les produits Glacier Bay sont garantis à l'acheteur original d'être exempt de vices de matériaux ou de fabrication. Nous remplacerons GRATUITEMENT tout produit ou pièce qui s'avèrera être défectueuse. Retourner tout simplement le produit/pièce à l'un des magasins The Home Depot ou composer le 1-855-HDGLACIER (1-855-434-5224) pour recevoir un article de remplacement. Une preuve d'achat (facture originale) de l'acheteur original doit être mise à la disposition de toute réclamation de Glacier Bay.

Cette garantie exclut tous dommages directs ou indirects et toutes défectuosités découlant d'une mauvaise utilisation ou d'une utilisation abusive ou de l'usure et de la détérioration normales. Cette garantie exclut tout usage industriel, commercial et d'affaire, dont les acquéreurs ont par les présentes, étendu une garantie limitée de cinq ans à partir de la date d'achat, avec toutes les autres conditions de cette garantie sauf la durée de la garantie.

Certains états et provinces n'autorisent pas l'exclusion ou la limitation de dommages circonstanciels ou conséquents, dans ce cas, cette disposition ne s'appliquerait pas. Cette garantie vous donne des droits légaux spécifiques et vous pouvez également avoir d'autres droits, qui varient d'une province à l'autre. Veuillez visiter un magasin ou appeler le 1-855-HDGLACIER pour plus de détails.

Préinstallation

PLANIFICATION DE L'INSTALLATION

Cette armoire à pharmacie est conçue pour une installation encastrée dans une ouverture de mur standard de 14 po de largeur, 24 po ou 34 po de haut, et 3½ po (ou plus) de profondeur.



REMARQUE : Un kit de montage est offert à l'achat auprès de Home Depot si vous souhaitez installer cette armoire de pharmacie directement sur un mur. Numéro de modèle GBF26.

OUTILS NÉCESSAIRES



Crayon



Lunettes de sécurité

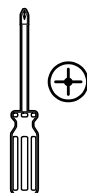

Tournevis Phillips



Niveau



Ruban à mesurer



Localisateur de montant

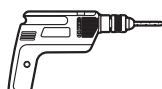

Perceuse



Mèches de ,078

MATÉRIEL INCLUS



REMARQUE : Matériel non représenté à la taille réelle.



AA

Pièce	Description	Quantité
AA	Vis de fixation	4

Préinstallation (suite)

CONTENU

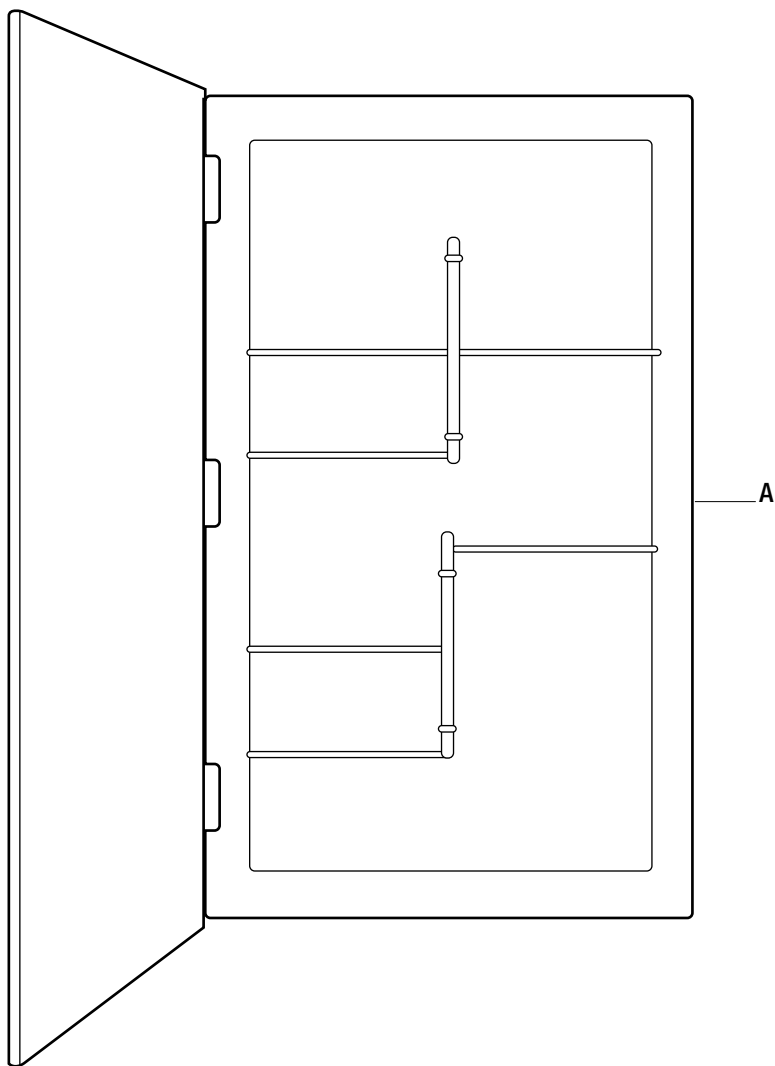

Pièce	Description	Quantité
A	Armoire à pharmacie	1

Installation

1 Préparation de l'installation

AVIS : Toute obstruction électrique ou de plomberie devrait être retirée par un professionnel qualifié avec une stricte conformité avec les codes du bâtiment en vigueur.

- Pour remplacer une armoire existante, retirer l'ancienne armoire et vérifier que l'ouverture dans le mur est de 14 po de large, 24 po de haut, et 3½ po (ou plus) de profondeur. Veuillez passer à l'étape 2 si ces dimensions sont correctes.
- Pour une nouvelle installation, sélectionner une ouverture dans le mur qui est centrée entre les montants de cloison qui sont positionnés à tous les 16 po. Utiliser un localisateur de montant pour localiser les montants.
- Le centre de l'ouverture du mur est généralement situé à 60 po au-dessus du plancher. Modifier cette dimension pour l'adapter aux besoins individuels ou pour faciliter le dégagement entre le haut ou le bas du miroir articulé et les obstacles tels que comptoir, robinet, prise électrique, éclairage, plafond, etc.
- Marquer et couper une ouverture de 14 po de large et de 24 po de haut, dans le mur. Utiliser un niveau pour s'assurer que les lignes de coupe sont de niveau avant de commencer à découper le mur.

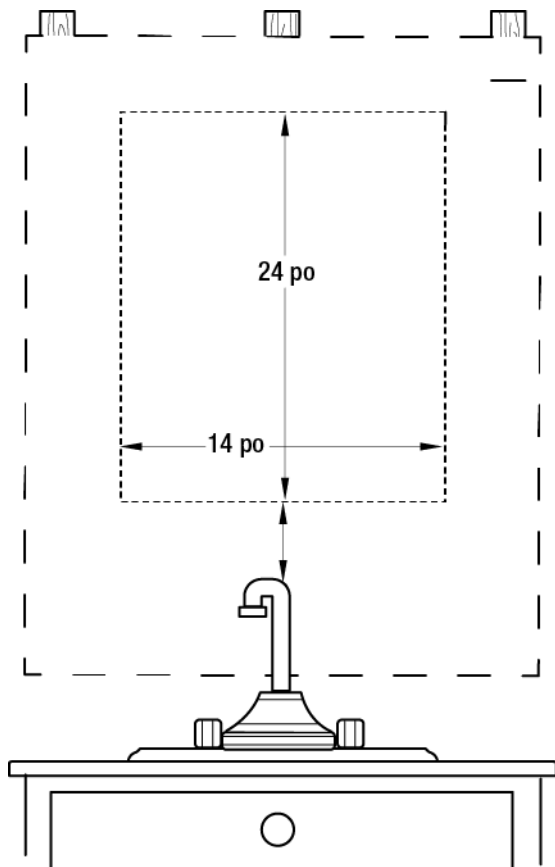

2 Fixation de l'armoire

- Placer l'armoire dans l'ouverture dans le mur avec le haut de la bride de retour du corps de l'armoire maintenue entièrement contre le mur. En notant le système de fixation à l'intérieur de l'armoire, positionner les vis de fixation (AA) à un angle de 15°, installer deux vis (AA) dans les trous de fixation supérieurs à l'intérieur de l'armoire. Utiliser uniquement les vis fournies (ne pas utiliser de clous). Ne pas serrer complètement les têtes de vis dans les cavités; laisser environ ¼ po de filetage apparent. Pour faciliter l'installation, marquer et percer ,078 po de diamètre de trous pilotes (à l'angle de 15°) sur les montants ou enduire les filetages de vis avec du savon.
- Installer deux vis (AA) dans les trous de fixation inférieurs. Laisser ¼ po du filetage apparent.
- Certains murs ne sont pas plats et d'aplomb. En utilisant un niveau de charpentier, ajuster si nécessaire pour mettre à niveau l'armoire comme illustré, face à l'armoire et vu de côté. Vérifier l'ajustement de la porte de l'armoire à la bride du corps de l'armoire. Corriger tout écart entre la porte et le corps par un nivellement par calage entre le mur et la bride du corps, dans le coin diagonalement opposé à l'écart. (Exemple : Si l'écart est dans la partie supérieure droite, la cale devrait être placée dans la partie inférieure gauche). Régler l'épaisseur de la cale pour l'alignement de l'axe transversal pour obtenir un ajustement adéquat entre la porte et le corps.
- Serrer les quatre vis de montage (AA) jusqu'à ce que les têtes de vis soient simplement logées dans leurs cavités. **NE PAS TROP VISSER!**

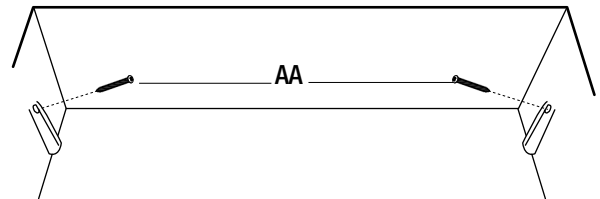

Entretien et nettoyage

- Le meilleur nettoyant et le plus sécuritaire pour un miroir est de l'eau propre utilisée avec un chiffon doux.
- Ne jamais vaporiser quoi que ce soit directement sur un miroir. Au lieu de cela, appliquer le nettoyant sur un chiffon doux, puis essuyer le miroir.
- Ne jamais utiliser d'acide, d'alcali, d'abrasifs ou de produits à base d'ammoniaque; ils sont susceptibles de détruire le miroir et annuleront la garantie.
- Éviter de faire des coulisses et de « flaques » sur les bords du miroir.
- Sécher soigneusement tous les bords du miroir.
- Les armoires à pharmacie devraient être les derniers éléments installés dans toute nouvelle construction afin d'éviter tout contact avec des solvants, des produits de nettoyage, etc.
- Dans les climats humides, installer des miroirs après que la climatisation soit opérationnelle.
- Une bonne ventilation évitera que les miroirs « suent » et créent une condensation nuisible.



**Questions, problèmes, pièces manquantes? Avant de retourner au magasin,
appelez le service à la clientèle de Glacier Bay
de 8h à 18h, heures normales de l'Est, du lundi au vendredi**

1-855-HD-HAMPTON

HOMEDEPOT.COM

Conservez ce manuel pour référence future.

Item #1000 000 000
Model #QP1301LX-07/CR

Item #1000 000 000
Model #QP1301LX-07/BK
Item #1000 000 000
Model #QP1301LX-07/BN

HAMPTON BAY®

USE AND CARE GUIDE

WOODBURY LED ADJUSTABLE COLOR INTERIOR VANITY

T24

Can be used to
comply with
California Title
24 High Efficacy
requirements

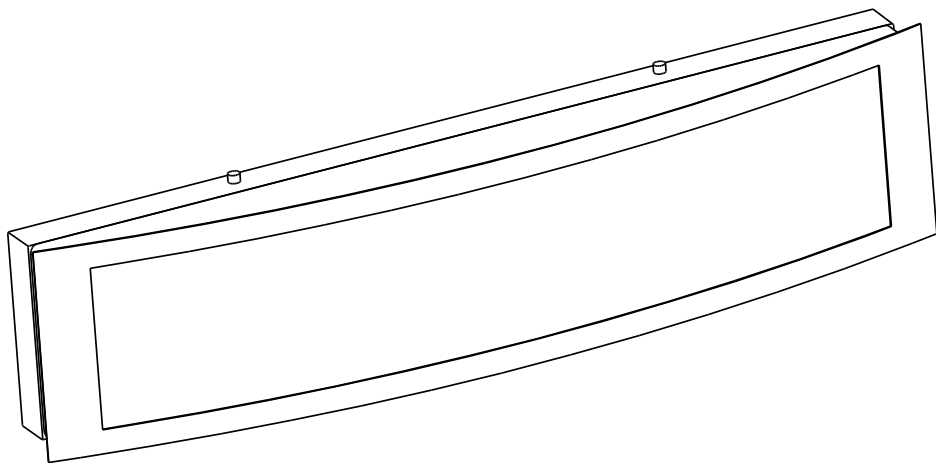

Questions, problems, missing parts? Before returning to the store,
call Hampton Bay Customer Service
8 a.m. - 7 p.m., EST, Monday - Friday, 9 a.m. - 6 p.m., EST, Saturday

1-855-HD-HAMPTON

HAMPTONBAY.COM

THANK YOU

We appreciate the trust and confidence you have placed in Hampton Bay through the purchase of this LED interior vanity. We strive to continually create quality products designed to enhance your home. Visit us online to see our full line of products available for your home improvement needs. Thank you for choosing Hampton Bay!

Table of Contents

Table of Contents	2	Tools Required	3
Safety Information	2	Hardware Included	3
Warranty	2	Package Contents	4
What is Covered	2	Installation	5
What is Not Covered	2	Care and Cleaning	7
Pre-Installation	3	Troubleshooting	7
Planning Installation.....	3		

Safety Information



WARNING: Carefully read and understand the information given in this manual before beginning the assembly and installation. Failure to do so could lead to electric shock, fire or other injuries which could be hazardous or even fatal.



WARNING: Be sure the electricity to the wires you are working on is shut off. Either remove the fuse or turn the circuit off.

NOTICE: Changes or modifications not expressly approved by the party responsible for compliance could void the user's authority to operate the equipment.

NOTICE: This equipment has been tested and found to comply with the limits for a Class B digital device, pursuant to Part 15 of the FCC Rules.

These limits are designed to provide reasonable protection against harmful interference in a residential installation. This equipment generates, uses and can radiate radio frequency energy and, if not installed and used in accordance with the instructions, may cause harmful interference to radio communications. However, there is no guarantee that interference will not occur in a particular installation.

If this equipment does cause harmful interference to radio or television reception, which can be determined by turning the equipment off and on, the user is encouraged to try to correct the interference by one or more of the following measures:

- Reorient or relocate the receiving antenna.
- Increase the separation between the equipment and receiver.
- Connect the equipment into an outlet on a circuit different from that to which the receiver is connected.
- Consult the dealer or an experienced radio/TV technician for help.

Warranty

WHAT IS COVERED

The manufacturer warrants this lighting fixture to be free from defects in materials and workmanship for a period of five (5) years from date of purchase. This warranty applies only to the original consumer purchaser and only to products used in normal use and service. If this product is found to be defective, the manufacturer's only obligation, and your exclusive remedy, is the repair or replacement of the product at the manufacturer's discretion, provided that the product has not been damaged through misuse, abuse, accident, modifications, alterations, neglect or mishandling.

WHAT IS NOT COVERED

This warranty shall not apply to any product that is found to have been improperly installed, set-up, or used in any way not in accordance with the instructions supplied with the product. This warranty shall not apply to a failure of the product as a result of an accident, misuse, abuse, negligence, alteration, or faulty installation, or any other failure not relating to faulty material or workmanship. This warranty shall not apply to the finish on any portion of the product, such as surface and/or weathering, as this is considered normal wear and tear.

The manufacturer does not warrant and specifically disclaims any warranty, whether express or implied, of fitness for a particular purpose, other than the warranty contained herein. The manufacturer specifically disclaims any liability and shall not be liable for any consequential or incidental loss or damage, including but not limited to any labor / expense costs involved in the replacement or repair of said product.

Contact the Customer Service Team at 1-855-HD-HAMPTON or visit HAMPTONBAY.COM.

Pre-Installation

PLANNING INSTALLATION

Read all instructions before assembly. Before starting installation of this fixture or removal of a previous fixture, disconnect the power by turning off the circuit breaker or by removing the fuse at the fuse box. To avoid damaging this product, assemble it on a soft, non-abrasive surface such as carpet or cardboard.



NOTE: Keep your receipt and these instructions for proof of purchase.

TOOLS REQUIRED

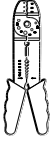

Wire Strippers



Safety Goggles



Ladder



Gloves



Flathead Screwdriver



Phillips Screwdriver



Electrical Tape



Wire Cutters



Drill

HARDWARE INCLUDED



NOTE: Hardware not shown to actual size.

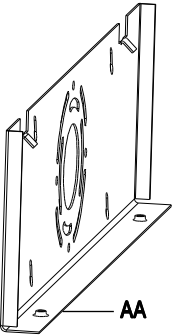

AA



BB



CC



DD



EE



FF

Part	Description	Quantity
AA	Mounting Plate	1
BB	Set Screw (20 mm long)	2
CC	Wire Connector	3
DD	Ground Screw	1
EE	Self-Threading Screw (25 mm long)	4
FF	Plastic Anchor (25 mm long)	4

Pre-Installation (continued)

PACKAGE CONTENTS

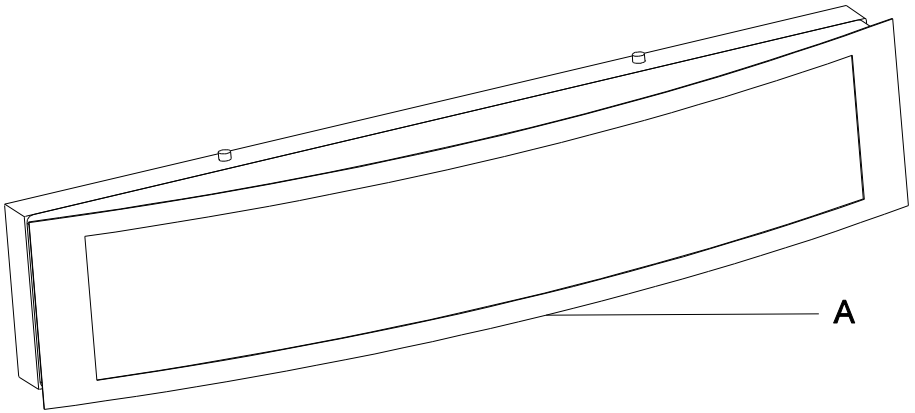

Part	Description	Quantity
A	Fixture Body	1

 CAUTION: The fixture body (A) is one piece. Do not disassemble it.

Installation

1 Attaching the mounting plate to the wall

- Place the mounting plate (AA) over the outlet box (sold separately), so the outlet box can be seen in the circle in the center of the mounting plate (AA).
- Use a pencil (sold separately) to gently mark the location of the four keyholes on the wall.
- Remove the mounting plate (AA) from the wall. Use a drill to bore four 5 mm deep holes in the wall, placing the holes following the location of the four keyholes on the mounting plate (AA).
- Insert the plastic anchors (FF) into the holes on the wall.
- Lightly screw the self-threading screws (EE) into the plastic anchors (FF). Be sure to leave about 1/8 in. between the heads of the self-threading screws (EE) and the wall.
- Place the mounting plate (AA) onto the protruding heads of the self-threading screws (EE).
- Gently pull down on the mounting plate (AA) until the heads of the self-threading screws (EE) slide into the narrow ends of the keyholes.
- Ensure the wires from the outlet box are either inside the outlet box, or through the hole in the center of the mounting plate (AA).

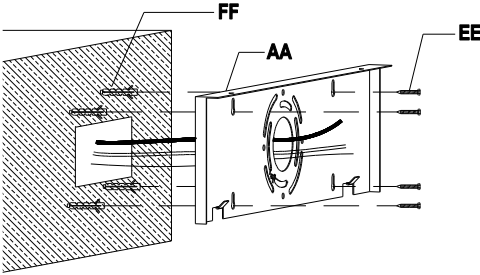

2 Connecting the electrical wires

- Wrap the middle of the ground wire from the fixture around the ground screw (DD) on the mounting plate (AA). Use a wire connector (CC) to connect the end of the ground wire from the fixture to the ground wire from the outlet box.
- Use a wire connector (CC) to connect the white wire from the fixture to the white wire (neutral wire) from the outlet box.
- Use a wire connector (CC) to connect the black wire from the fixture to the black wire (live wire) from the outlet box.
- Wrap the three wire connections with electrical tape for a more secure connection.
- Position the wires inside the outlet box.

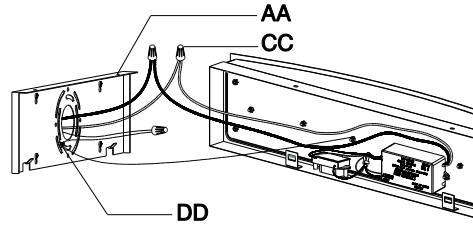

Installation (continued)

3 Securing the fixture to the mounting plate

- Align the tabs on the bottom of the mounting plate (AA) with the mounting holes on the bottom of the fixture body (A).
- Place the fixture body (A) against the mounting plate (AA).
- Screw the mounting screws (BB) into the two holes on top of the fixture body (A) to secure it onto the mounting plate (AA).

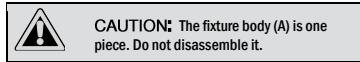
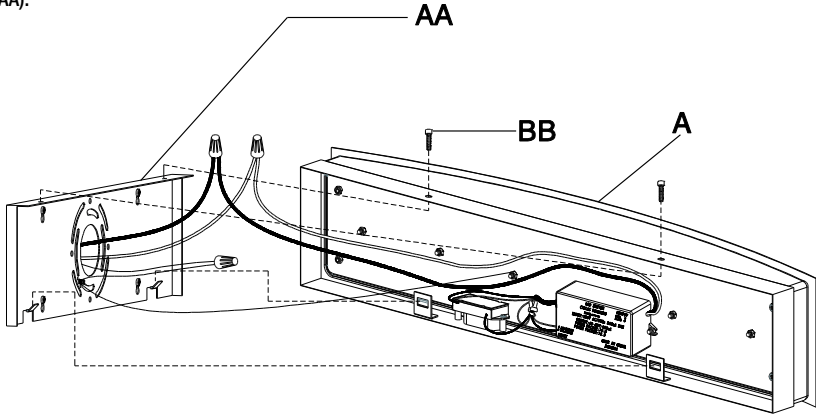

4 Selecting the CCT option

- Choose your preferred correlated color temperature (CCT) from the five options: 2700K warm white, 3000K soft white, 3500K neutral white, 4000K bright white, or 5000K daylight.
- Move the CCT switch on the fixture (A) side-to-side to make your selection.

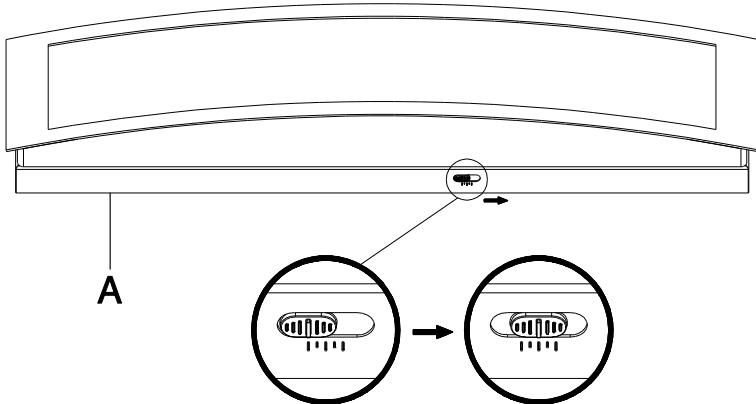

Care and Cleaning



CAUTION: Before attempting to clean the fixture, disconnect the power to the fixture by turning the breaker off or removing the fuse from the fuse box.

- Clean the fixture with a soft, dry cloth.
- Do not use any cleaners with chemicals, solvents, or harsh abrasives.

Troubleshooting

Problem	Possible Cause	Solution
The fixture will not light.	The power is off.	Ensure the power supply is On.
	The circuit breaker is off.	Ensure the circuit breaker is in the On position.
The fuse blows or circuit breaker trips when the light is turned on.	The wires are crossed or the power wire is grounding out.	<ul style="list-style-type: none"><input type="checkbox"/> Check the wire connections.<input type="checkbox"/> Contact a qualified electrician or call the Customer Service Team at 1-855-HD-HAMPTON.

HAMPTON BAY®

Questions, problems, missing parts? Before returning to the store,
call Hampton Bay Customer Service
8 a.m. - 7 p.m., EST, Monday - Friday, 9 a.m. - 6 p.m., EST, Saturday

1-855-HD-HAMPTON

HAMPTONBAY.COM

Retain this manual for future use.

TECHNICAL DATA

Futura[®]

TOILET PAPER HOLDER

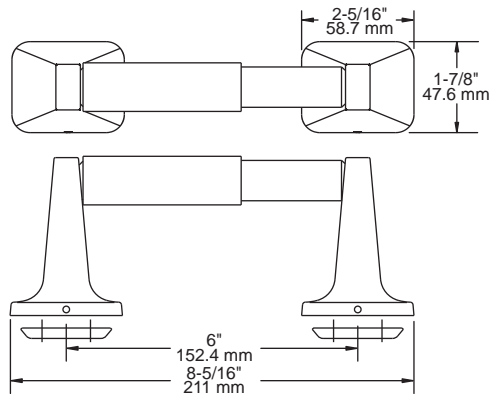
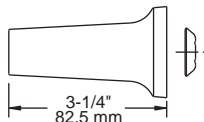

MATERIALS:
 Posts - Zinc Die Cast
 Roller - Plated Plastic
 Wall Plate - Steel, Nickel Plated

INSTALLATION: Mount wall plate bracket(s) per installation instructions with supplied fasteners. Slip product over wall plate(s) and tighten set screws until secure.

OPTIONAL FASTENER INFORMATION:
 Wood blocking is preferable behind all wall surfaces. If wood blocking is not available, the following fasteners are suggested: Tile/Masonry - Plastic or Lead Anchors, Plaster/Drywall - Toggle Bolts

SPECIFICATION: Surface mounted toilet paper holder shall be model _____
 (fill in model number) by Liberty Hardware Manufacturing Corporation.

USE AND CARE GUIDE



LED INTERIOR TWIN PACK FLUSHMOUNT

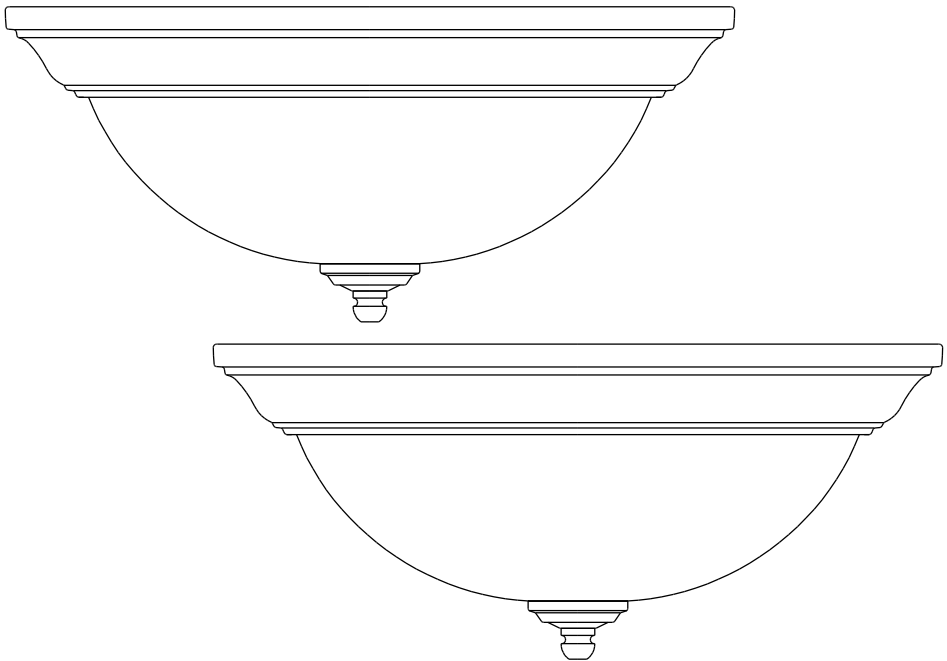

Questions, problems, missing parts? Before returning to the store
call Commercial Electric Customer Service
8 a.m. - 7 p.m., EST, Monday - Friday, 9 a.m. - 6 p.m., EST, Saturday

1-877-527-0313

HOMEDEPOT.COM

THANK YOU

We appreciate the trust and confidence you have placed in Commercial Electric through the purchase of these LED interior flushmounts. We strive to continually create quality products designed to enhance your home. Visit us online to see our full line of products available for your home improvement needs. Thank you for choosing Commercial Electric!

USE AND CARE GUIDE



LED INTERIOR TWIN PACK FLUSHMOUNT

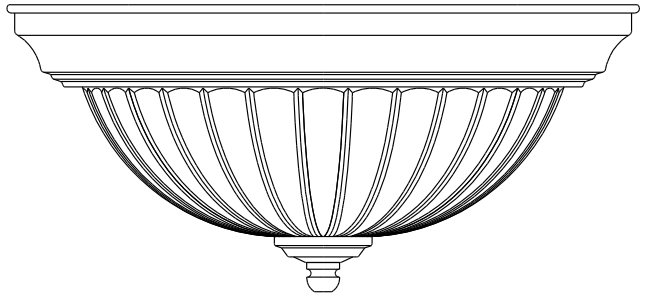
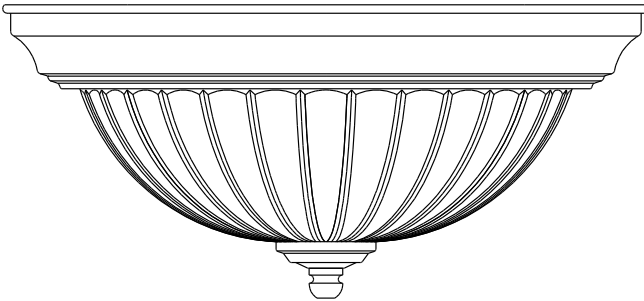

Questions, problems, missing parts? Before returning to the store,
call Commercial Electric Customer Service
8 a.m. - 6 p.m., EST, Monday - Friday

1-877-527-0313

HOMEDEPOT.COM

THANK YOU

We appreciate the trust and confidence you have placed in Commercial Electric through the purchase of this LED interior flushmount. We strive to continually create quality products designed to enhance your home. Visit us online to see our full line of products available for your home improvement needs. Thank you for choosing Commercial Electric!

Description

The Halo RL4 SeleCCTable™ is a complete LED Baffle-Trim Module for 4-inch aperture recessed downlights; suitable for new construction, remodel and retrofit installation. Using the CCT selectable switch users can chose between five different color temperatures. The lens provides uniform illumination and wet location listing. Precision construction makes any housing AIR-TITE for added savings and code compliance.

Catalog #		Type
Project		
Comments		Date
Prepared by		

Specification Features

CCT Select System

- Use the switch to choose between 2700K, 3000K, 3500K, 4000K, and 5000K CCT.

Module - Trim

- Module construction includes LED array, heat sink, reflector, lens, baffle and trim ring.
- Regressed baffle
- Heat sink designed to conduct heat away from the LED array, keeping the junction temperatures below specified maximums, even when installed in insulated ceiling environments.

LED Array

- Mid power LED array provides a uniform source with high efficiency and no pixilation.
- 90 CRI minimum, R9 greater than 50
- Color accuracy at 4 SDCM in between endpoints, provide color accuracy and uniformity.
- Color Temperature (CCT) has a selectable range from 2700K to 5000K (factory default 3000K)

Optical Assembly

- Regressed lens
- Impact-resistant polycarbonate
- Convex form and lamp-like appearance
- Diffuse for even illumination

Driver

- Integral 120V 60 Hz constant current driver provides noise free operation
- Continuous, flicker-free dimming from 100% to 5%.
- Inline electrical quick connect and E26 adapter (provided) provides mains connections
- See Dimming Guide for compatible dimmers

Retention

- Push-N-Twist universal installation clips
- Clips are pre-installed and designed to fit 4" compatible recessed housings

Designer Skins (sold separately)

- RL4 skins are accessory rings that attach to the RL4 for a permanent finish. Refer to the RL4 accessories specification sheet for details.
 - White (Paintable)
 - Satin Nickel
 - Tuscan Bronze

Gaskets

- Closed cell gaskets achieve restrictive airflow requirements without additional caulking

Compliance

- UL Certified
- Wet and Damp location listed
- Airtight certified per ASTM-E283
- Suitable for use in clothes closets when installed in accordance with the NEC 410.16 spacing requirements
- EMI/RFI emissions per FCC 47CFR Part 15 consumer limits
- Contains no mercury or lead and RoHS compliant
- Photometric testing in accordance with IES LM-79-08
- Lumen maintenance projections in accordance with IES LM-80-08 and TM-21-11
- Can be used for State of California Title 24 high efficacy luminaire compliance. Complies with Title 24 JA8-2016-E.
- Can be used International Energy Conservation Code (IECC) high efficiency luminaire compliance.
- ENERGY STAR® listed, reference database for current listings

Warranty

Five year limited warranty, consult website for details.
www.eaton.com/lighting/legal



RL4069S1EWH



RL4099S1EWH

RL4

4-Inch All-Purpose LED Retrofit Module with SeleCCTable switch

up to 1006 lumens

FOR USE IN INSULATED CEILING AND NON- INSULATED CEILING RATED HOUSINGS

HIGH-EFFICACY LED WITH INTEGRAL DRIVER - DIMMABLE



Refer to ENERGY STAR® Certified Products List. Can be used to comply with California Title 24 High Efficacy requirements. Certified to California Appliance Efficiency Database under JA8.



Energy Data

RL4069S1EWH	
Max. Lumens	621 @ 4000K
Input Voltage	120V
Input Frequency	50/60 Hz
Input Power	7.6W
Input Current	0.075A - 0.0875A (Per input power)
Power Factor	>0.90
THD	<20%
EMI/RFI	FCC Title 47 CFR, Part 15, Class B (Consumer)
Sound Rating	Class A
Minimum Starting Temp	-30°C (-22°F)

RL4099S1EWH	
Max. Lumens	1006 @ 5000K
Input Voltage	120V
Input Frequency	50/60 Hz
Input Power	11.7W
Input Current	0.075A - 0.0875A (Per input power)
Power Factor	>0.90
THD	<20%
EMI/RFI	FCC Title 47 CFR, Part 15, Class B (Consumer)
Sound Rating	Class A
Minimum Starting Temp	-30°C (-22°F)

Dimensions

600 Series

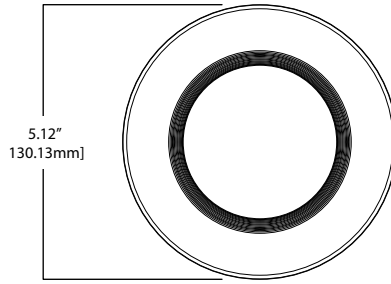
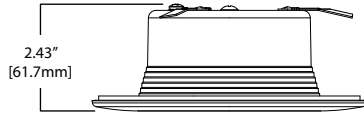

Ordering Information

SAMPLE NUMBER: RL4069S1EWH

A complete luminaire consists of a housing, and LED module, order separately.

Models	Lumens	CRI/CCT	Driver	Finish	Accessories
RL4 = 4" all- purpose retrofit LED module	06 =600 lumens (nominal) 09 =900 lumens (nominal)	9S =90 CRI minimum, white tuning, selectable CCT 2700K-5000K	1E = 120V 60Hz leading or trailing edge phase cut 1% dimming	WH =Matte white baffle	RL4TRMWHB =4" White Paintable Trim Ring, Baffle RL4TRMSNB =4" Satin Nickel Trim Ring, Baffle RL4TRMTBZB =4" Tuscan Bronze Trim Ring, Baffle RL4TRMWH =4" White Paintable Trim Ring RL4TRMSN =4" Satin Nickel Trim Ring RL4TRMTBZ =4" Tuscan Bronze Trim Ring

Housings

Halo Ultra-shallow LED Housings

- H245ICAT**=4" IC, airtight ultra-shallow new construction housing, LED, 120 - 277V
- H245RICAT**=4" IC, airtight ultra-shallow remodeler housing, LED, 120 - 277V

Halo LED Housings

- H995ICAT**=4" IC, airtight shallow new construction housing, LED, 120 - 277V
- H995RICAT**=4" IC, airtight shallow remodeler housing, LED, 120 - 277V

Halo Housings

- H99TAT**=4" non-IC, airtight shallow new construction housing, E26, 120V
- H99RTAT**=4" non-IC, airtight shallow remodeler housing, E26, 120V
- H99ICAT**=4" IC, airtight shallow new construction housing, E26, 120V
- E4TATSB**=4" non-IC, airtight shallow new construction housing, adjustable socket bracket, E26, 120V
- E4RTATSB**=4" non-IC, airtight shallow remodeler housing, adjustable socket bracket, E26, 120V
- E4ICATSB**=4" non-IC, airtight shallow new construction housing, adjustable socket bracket, E26, 120V

Photometric Data

RL4069S1EWHR-3000K		
Luminaire lumens		575
Input watts		7.6
LER (LPW)		75.7
Spacing Criteria	0-180	1.18
	90-270	1.18
	Diagonal	1.26
Beam angle (degrees)		93.1
Field angle (degrees)		141.1
Zonal lumen	Lumens	% Lumens
0-30	203	35.3
0-40	322	56
0-60	511	88.8
0-90	575	100

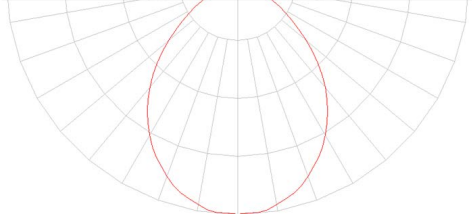

* Tested in accordance with IES LM63. Field results may vary.

RL4099S1EWHR-3000K		
Luminaire lumens		915
Input watts		11.7
LER (LPW)		78.2
Spacing Criteria	0-180	1.17
	90-270	1.17
	Diagonal	1.25
Beam angle (degrees)		93
Field angle (degrees)		141.1
Zonal lumen	Lumens	% Lumens
0-30	323	35.3
0-40	512	56
0-60	813	88.8
0-90	915	100

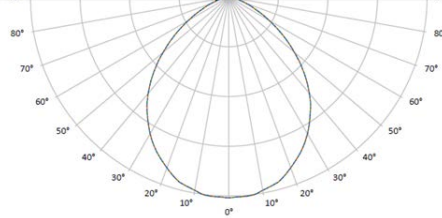

* Tested in accordance with IES LM63. Field results may vary.

Color Metric Summary

TM-30-15	R _r = 91.1
	R _g = 100.9
CRI/CIE	R _a = 93.1
	R ₉ = 64.9



CCT - Range of 2700K- 5000K

Color Metric Summary

TM-30-15	R _r = 91.1
	R _g = 100.9
CRI/CIE	R _a = 93.1
	R ₉ = 64.9



CCT - Range of 2700K- 5000K

Product Specifications

PRODUCT SPECIFICATIONS

Lumens	575
Watts	7.6
Lumens Per Watt (Efficacy)	75.66
Color Accuracy (CRI)	91
Light Color (CCT) Correlated Color Temperature (CCT)	3000K

PRODUCT SPECIFICATIONS

Lumens	915
Watts	11.7
Lumens Per Watt (Efficacy)	78.2
Color Accuracy (CRI)	92
Light Color (CCT) Correlated Color Temperature (CCT)	3000K

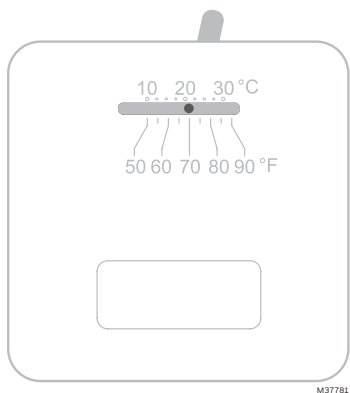

M37781

Owner's Manual

English: Page 1

Mode d'emploi

Français : Page 6

Manual de Uso

Español: Página 11

CT30 Series

Low-Voltage Thermostat

Getting started

Check package contents:

- Thermostat
- Coverplate
- Wall anchors & screws (2 each)
- Caution card
- Wire labels

Before you begin, make sure you have:

- No. 2 Phillips & small pocket screwdrivers
- Hammer
- Level (optional)
- Pencil
- Drill and bit (3/16" for drywall, 7/32" for plaster)

Remove your old thermostat



TURN OFF POWER at heating/cooling system (or fuse/circuit-breaker panel).

Remove cover and thermostat, but leave wallplate with wires attached.

Leave wallplate in place.

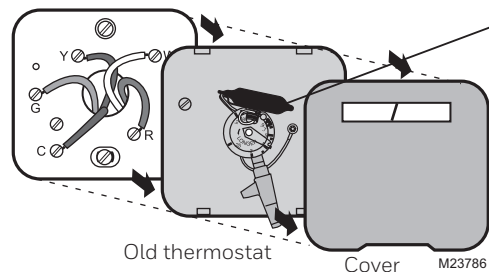

Is there a sealed tube containing mercury?
If so, see [mercury notice](#) below.



MERCURY NOTICE

If your old thermostat contains mercury, contact your local waste management authority for proper disposal instructions.



69-2338EFS-04



Worry-Free

Ten Year Sealed Battery Smoke Alarms

Worry-Free Kitchen Smoke and Carbon Monoxide Alarm Sealed Lithium Battery Power

Model P3010K-CO

Test/Hush Button

A single button that tests alarm circuitry and temporarily silences nuisance alarms.

LED Indicator

A flashing red indicator blinks to correspond with alarm sound, unit error mode, and standby condition.

Combined Smoke and Carbon Monoxide Alarm

Unique sensor algorithm detects real fires faster and reduces cooking-related nuisance alarms.

Sealed-In Lithium Battery

Unit will continue to operate for 10 years. Alerts user to replace alarm after 10 years of operation.



Description

The Kidde P3010K-CO is a 10-year, sealed battery, smoke and carbon monoxide alarm that features photoelectric and electrochemical sensing technology with Smart Hush feature. This combination alarm combines the detection capabilities of a photoelectric sensor with that of an electrochemical sensor, which is used to detect CO. When either sensor notices a potential hazard, it will communicate with the other. Depending on what is detected, the alarm will adjust its smoke sensitivity in order to better discriminate between a real hazard and a false one. This constant communication enhances the alarm's overall performance and significantly reduces the potential for a nuisance alarm.

The sealed in lithium battery will power the unit for the entirety of its 10 year life, eliminating the need for battery replacement and worry about unauthorized battery removal. The alarm provides continuous protection from smoke and carbon monoxide, even during power outages.

The alarm will automatically activate when it is attached to the mounting bracket; there are no pull-tabs, no switches, everything is automatic. At the end of alarm life, the unit will chirp, indicating the alarm is in need of replacement. The customer can use a simple tool such as a screwdriver to deactivate the unit, stopping the chirp and making it safe for disposal.

Industry experts (such as the NFPA), recommend that both ionization and photoelectric smoke alarms be installed to help insure maximum detection of the various types of fires that can occur within the home. Ionization sensing alarms may detect invisible fire particles (associated with fast flaming fires) sooner than photoelectric alarms. Photoelectric sensing alarms may detect visible fire particles (associated with slow smoldering fires) sooner than ionization alarms.

Features and Benefits

- **Combination Smoke and Carbon Monoxide Alarm** – Smoke and CO sensing technologies work together to detect real fires faster and reduce cooking-related nuisance alarms.
- **Sealed-In Lithium Battery** – Sealed-in lithium power supply; no battery replacement required over the 10 year life of the alarm. Eliminates worry about battery removal or unauthorized deactivation of alarm.
- **Photoelectric Sensor** – Smoke alarm contains advanced photoelectric sensor that may detect visible particles (associated with smoldering fires) sooner than ionization alarms.
- **Self Activation** – Alarm automatically activates when attached to the mounting bracket.
- **Alarm Memory** – Rapidly flashing LED alerts user if the alarm has sounded since the last time the test/reset button was used.
- **Test/Hush Button** – Tests alarm circuitry and activates Hush features.
- **Smart Hush™** – Temporarily silences nuisance alarms for approximately 10 minutes and will not allow hush mode unless the unit is in alarm mode.
- **LED** – Red LED will blink in conjunction with the alarm sound.
- **End of Life Warning** – Alarm chirps every 30 seconds to indicate the unit is in need of replacement.
- **End of Life Hush®** – End of life indication can be silenced three days at a time up to 30 days to allow for alarm replacement at a more convenient time.
- **UL217 and UL2034 Listed**
- **10 Year Limited Warranty**



Architectural and Engineering Specifications

The combination smoke and carbon monoxide alarm shall be Kidde model number P3010K-CO or approved equal. It shall be powered by a non-replaceable lithium battery with a 10-year life. The lithium battery shall be sealed in the unit to prevent removal and/or tampering. The unit shall incorporate a photoelectric smoke sensor and an electrochemical carbon monoxide sensor. The CO sensor shall be of a fuel cell design and provide accuracy of +/- 20% + 15 PPM. The temperature operating range shall be between 40°F and 100°F (4°C and 38°C) and the humidity operating range shall be 10%-85% non-condensing relative humidity.

The alarm can be installed on the surface of any wall or ceiling following the UL/Manufacturer's approved placement guidelines. The alarm shall incorporate an automatic activation feature that will activate the unit as soon as it is attached to the mounting bracket, no other steps are involved.

The alarm shall include a test button that will electronically simulate the presence of smoke and CO and cause the unit to go into both modes of alarm. This sequence tests the unit's electronics to ensure proper operation.

The CO sensor will not alarm to levels of CO below 30 PPM and will alarm in the following time range when exposed to the corresponding levels of CO.

70 PPM CO Concentration	60 – 240 Minutes
150 PPM CO Concentration	10 – 50 Minutes
400 PPM CO Concentration	4 – 15 Minutes

The alarm shall include a piezoelectric horn that is rated at 85 decibels at 10 feet. For a CO incident, the horn will sound in the repetitive manner – four (4) fast beeps, a short pause, four (4) fast beeps, a short pause. In a smoke incident, the horn will sound in the repetitive manner – three (3) beeps, a pause, three (3) beeps, a pause. The red LED will flash in conjunction with the alarm sound.

The unit shall indicate a low battery condition with a brief alarm chirp and LED flash once every 30 seconds. In standby condition, the LED will flash every 60 seconds for the first 10 minutes following power on or test, and once every 10 minutes thereafter. It will also flash every 10 seconds while in Hush mode.

The smoke alarm shall include an End of Life Alert, where ten years after initial power-up the unit shall chirp two times every 30 seconds to indicate the alarm needs to be replaced. The End of Life indication can be silenced for 3 days at a time for

a maximum of 30 days. The unit shall have a deactivation switch to disable it and make it safe for disposal.

The unit shall at a minimum meet the requirements of UL217, UL 2034, NFPA 72, (chapter 11 2002 edition) The State of California Fire Marshall, NFPA 101 (One and two family dwellings), Federal Housing Authority (FHA), Housing and Urban Development (HUD). It shall also include a 10-year manufacturer's limited warranty.

Technical Specifications

Model:	P3010K-CO
Power Source:	Sealed Lithium Battery
Sensor:	Smoke: Photoelectric CO: Electrochemical
Audio Alarm:	85dB at 10ft
Temperature Range:	40°F (4.4°C) to 100°F (37.8°C)
Humidity Range:	10%-85% non-condensing relative humidity (RH)
Size:	5.22" in diameter x 1.6" depth
Weight:	1 lb.
Interconnects:	No
Warranty:	10 year limited

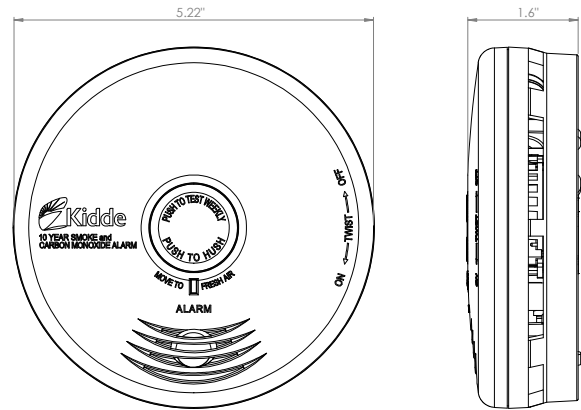

Ordering Information

Part No:	1 of 5	UPC	Pack Quantity	Dimensions (w" x d" x h")	Weight	Case/Skid	Skid Weight
21010170	100-47871-10061-0	0-47871-10061-3	3-PK (Clam)	7.25 x 1.75 x 11	1 lbs	N/A	N/A
21010071	100-47871-10071-9	0-47871-10071-2	6-PK (Box)	5.75 x 2 x 6.25	1 lbs	N/A	N/A

Distributed by:



1016 Corporate Park Drive
 Mebane NC 27302
 1-800-880-6788
 www.Kidde.com



Sealed Battery Smoke Alarm with Smart Hush™

Part Number 900-0136

Model 0910

LED Indicator

A flashing red indicator light with four modes of operation: Standby, alarm mode, hush mode and memory set

Test/Reset Button

One button tests the unit's circuit operation and resets memory after an alarm condition occurs

Smart Hush™ Feature

Temporarily silences nuisance alarms. Will not allow hush to be activated unless unit is in alarm mode.

Battery Operated

No wiring needed

Sealed-In Lithium Batteries

Unit will continue to operate for 10 years



Description

The Kidde 0910 is a 10-year, sealed battery, ionization, smoke alarm with Alarm Memory and Smart Hush™ feature. The innovative design of this alarm's automatic activation is unlike any other smoke alarm. The 0910 alarm will automatically activate when it is attached to the mounting bracket; there are no pull-tabs, no switches, everything is automatic. *At the end of the alarm life, the unit will chirp, indicating the alarm is in need of replacement.* The customer can use a simple tool such as a screwdriver to deactivate the unit, stopping the low battery chirp and making it safe for disposal.

The sealed-in board-mounted batteries will power the 0910 unit for its complete 10-year life. No replacement batteries will ever be needed.

This alarm uses ionization sensing technology. Ionization sensing alarms may detect invisible fire particles (associated with flaming fires) sooner than photoelectric alarms. Photoelectric sensing alarms may detect visible particles (associated with smoldering fires) sooner than ionization alarms.

Kidde strongly recommends that both ionization and photoelectric smoke alarms be installed to help insure maximum detection of the various types of fire that can occur within the home

The Kidde 0910 sealed battery operated smoke alarm features a self-activation mechanism making installation simple and easy. It also features Smart Hush™ Control allowing consumers to temporarily silence nuisance alarms and an End of Life Alert indicating it is time to replace the alarm.

At the end of the alarm's 10-year life, deactivation of the alarm is just as easy. Using a tool such as a small screwdriver, a deactivation switch removes power from the alarm and renders the batteries safe for disposal. The alarm lockout feature mechanically prevents a deactivated unit from being mounted back on the mounting bracket.

Features and Benefits

- **Sealed-In Lithium Battery** – Sealed-in lithium power supply; no battery replacement required over the 10 year life of the alarm. Eliminates worry about battery removal or unauthorized deactivation of alarm.
- **Self Activation** – Alarm automatically activates when attached to the mounting bracket.
- **Alarm Memory** – Rapidly flashing LED alerts user if the alarm has sounded since the last time the test/reset button was used.
- **Smart Hush™** – Will temporarily silence nuisance alarms and will not allow hush mode to be activated unless the unit is in alarm mode.
- **Test/Reset Button** – Tests unit's circuit operation and resets memory after an alarm condition occurs.
- **End of Life Warning** – Alarm chirps every 30-45 seconds indicating the alarm is in need of replacement.
- **Tamper Resist** – (when activated upon installation) effective in preventing someone from removing the unit from the mounting bracket.
- **LED** – A flashing red indicator light with four modes of operation: standby, alarm mode, hush mode, and memory set.



Architectural and Engineering Specifications

The smoke alarm shall be Kidde unit 0910/0910CA or approved equal. It shall be powered by a non-replaceable lithium battery with a 10-year life. The lithium battery shall be sealed in the unit to prevent removal and/or tampering. The unit shall incorporate an ionization sensor with nominal sensitivity of 0.99%/ft (.87%/ft for unit 0910CA). The temperature operating range shall be between 40°F and 100°F (4°C and 38°C) and the humidity operating range shall be 5% - 95% relative humidity.

The smoke alarm can be installed on the surface of any wall or ceiling following the UL/Manufacturer's approved placement guidelines. The alarm shall incorporate an automatic activation feature that will activate the unit as soon as it is attached to the mounting bracket, no other steps are involved. The alarm shall provide optional tamper resistance that locks the unit to the mounting bracket and deters removal of the unit from the wall or ceiling.

The alarm shall include a test button that will simulate a fire condition and cause the unit to go into alarm. This sequence tests the unit's electronics to ensure proper operation.

The unit shall include a piezoelectric horn that is rated at 85 decibels at 10 feet. The unit shall include the Smart Hush™ feature that silences the unit for approximately 7 minutes if a nuisance condition occurs. The red LED will illuminate for 1.5 seconds every 8 seconds and will automatically reset itself. If the alarm is in the Hush mode and the condition that triggered the alarm persists, the alarm shall sound again to signal potential danger despite its presence in Hush Mode. The unit shall incorporate one red LED to indicate the alarm's current status and mode of operation. The LED will indicate one of four modes:

- Standby Mode:** LED will flash every 40-45 seconds to indicate the unit is operating correctly
- Alarm Mode:** LED will flash every 1.5 seconds to indicate the unit is alarming and will be accompanied by the horn sounding
- Hush Mode:** LED will illuminate for 1.5 seconds every 8 seconds to indicate the unit is temporarily silenced
- Memory Set Mode:** If Alarm Memory has been set, the LED will flash rapidly when the test button is pressed.

The unit shall include an End of Life Alert which indicates the alarm needs to be replaced. The unit will "chirp" once every 30 seconds to notify the user. The unit shall have a deactivation switch to disable it and make it safe for disposal. The unit shall at a minimum meet the requirements of UL217, NFPA72, (chapter 11 2002 edition) The State of California Fire Marshall, NFPA101 (One and two family dwellings) Federal Housing Authority (FHA), Housing and Urban Development (HUD).

Technical Specifications

Model:	0910
UPC Number:	0-47871-90136-4
Power Source:	Three, 3V Lithium batteries
Sensor:	Ionization
Audio Alarm:	85dB at 10ft
Temperature Range:	40°F (4.4°C) to 100°F (37.8°C)
Humidity Range:	5%-95% relative humidity (RH)
Size:	5.6" in diameter x 1.55" depth
Weight:	1.5lbs
Interconnects:	No
LED:	Four modes of operation
Warranty:	10 year limited

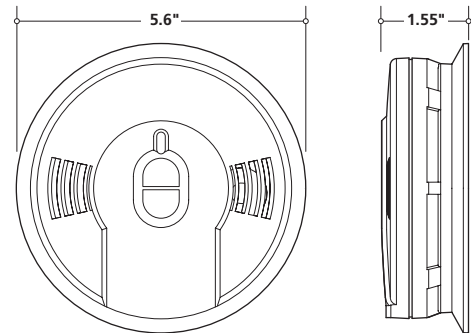

Ordering Information

Clamshell UPC: 0 47871 90136 4

Part Number	I 2 of 5	Pack Quantity	Dimensions (w x d x h inches)	Weight	Case/Skid	Layers/Skid	Skid Weight
900-0136 N/A	N/A	Individual	7.25 x 1.75 x 11	1 lbs	N/A	----	N/A
900-0136-003	100 47871 90136-1	PDQ (3 units)	7.75 x 6 x 11.75	3 lbs	108	----	972 lbs
900-0136-020	200 47871 90136-8	Master Pack (20 units)	16 x 24 x 12	20 lbs	12	----	240 lbs
21007387	400 47871 90136-2	4pc Tray and Lid	7.75 x 9.25 x 11.75	4 lbs	75	----	300 lbs



1016 Corporate Park Drive
Mebane NC 27302
1-800-880-6788
www.Kidde.com

Distributed by: