

TYPICAL SECTION
NTS

LEGEND AND NOTES

- DENOTES PROPERTY LINE
- DENOTES BUILDING FOOTPRINT
- DENOTES ROOF OUTLINE
- DENOTES ROOF RIDGES AND BREAKS

DIMENSIONS AND ELEVATIONS SHOWN ARE IN FEET AND DECIMALS.
ALL BUILDING DIMENSIONS ARE TAKEN TO OUTSIDE FACE OF TRIM.

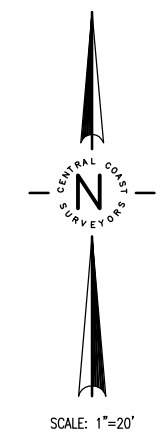

ROOFTOP SURVEY
FOR
1073 SHERMAN DRIVE

CITY OF SALINAS COUNTY OF MONTEREY STATE OF CALIFORNIA

PREPARED FOR
The Housing Authority of the County of Monterey

BY
CENTRAL COAST SURVEYORS
5 HARRIS COURT, SUITE N-11 MONTEREY, CALIFORNIA 93940
Phone: (831) 394-4930 Fax: (831) 394-4931

SCALE: 1" = 20' JOB No. 09-25 JUNE 2009
PREPARER: DTE

ARRA PROJECT NO. 120d CCS SUB NO. 10 ASSESSORS PARCEL NUMBER 261-721-024
Scattered Site - Sherman Drive Dwg 10

HOWE DRIVE
(A 54 FOOT WIDE CITY STREET)

SHERMAN DRIVE
(A 60 FOOT WIDE CITY STREET)