

TYPICAL SECTION
NTS

LEGEND AND NOTES

- DENOTES PROPERTY LINE
- - - DENOTES BUILDING FOOTPRINT
- 12.8' DENOTES ROOF OUTLINE OR PARAPET WITH HEIGHT WHERE LEVEL
- 5.5' DENOTES ROOF RIDGES WITH HEIGHT AND SLOPED BREAKS

DIMENSIONS AND ELEVATIONS SHOWN ARE IN FEET AND DECIMALS.
ALL BUILDING DIMENSIONS ARE TAKEN TO OUTSIDE FACE OF TRIM.
SMALL ANCILLARY ROOFTOPS FOR APPURTENENT ENCLOSURES SUCH AS UTILITY METER COVERS, MECHANICAL ROOMS, WATER HEATERS, EQUIPMENT AND SUPPLY CLOSETS, ETC., ARE NOT NECESSARILY SHOWN.

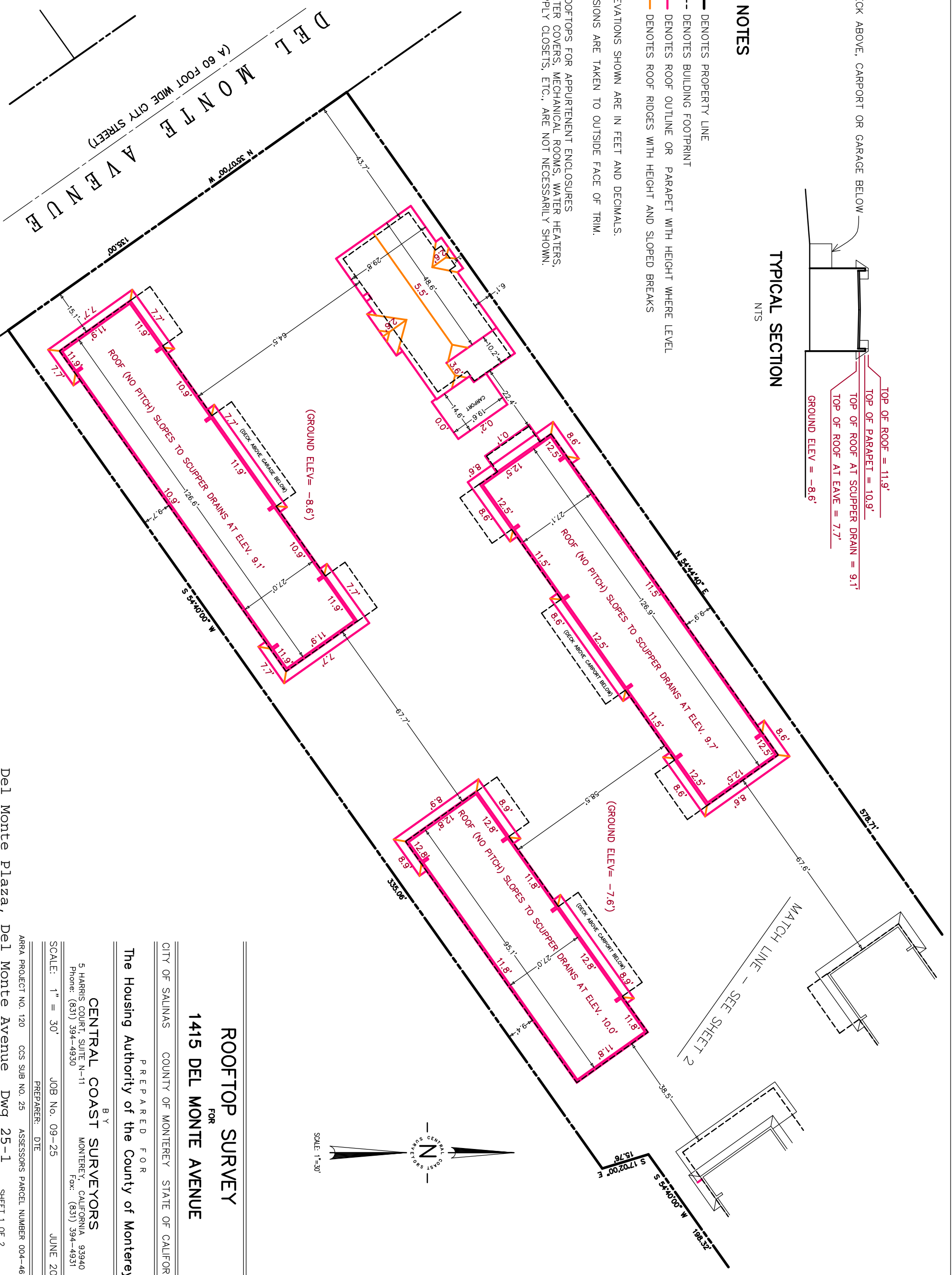

SCALE: 1"=30'

ROOFTOP SURVEY
FOR
1415 DEL MONTE AVENUE

CITY OF SALINAS COUNTY OF MONTEREY STATE OF CALIFORNIA
PREPARED FOR
The Housing Authority of the County of Monterey

B Y
CENTRAL COAST SURVEYORS
5 HARRIS COURT, SUITE N-11 MONTEREY, CALIFORNIA 93940
Phone: (831) 394-4930 Fax: (831) 394-4931
JOB No. 09-25 JUNE 2009
PREPARED BY: DTE